

APPARTEMENTSTEKENING  
CASANOVA  
ROTTERDAM

(Blad 1 van 3)

SCHAAL 1 : 200



Voorgenomen splitsing in 3  
appartementenrechten van het  
kadastrale perceel gemeente  
ROTTERDAM sectie AH nr.

CONCEPT14112018

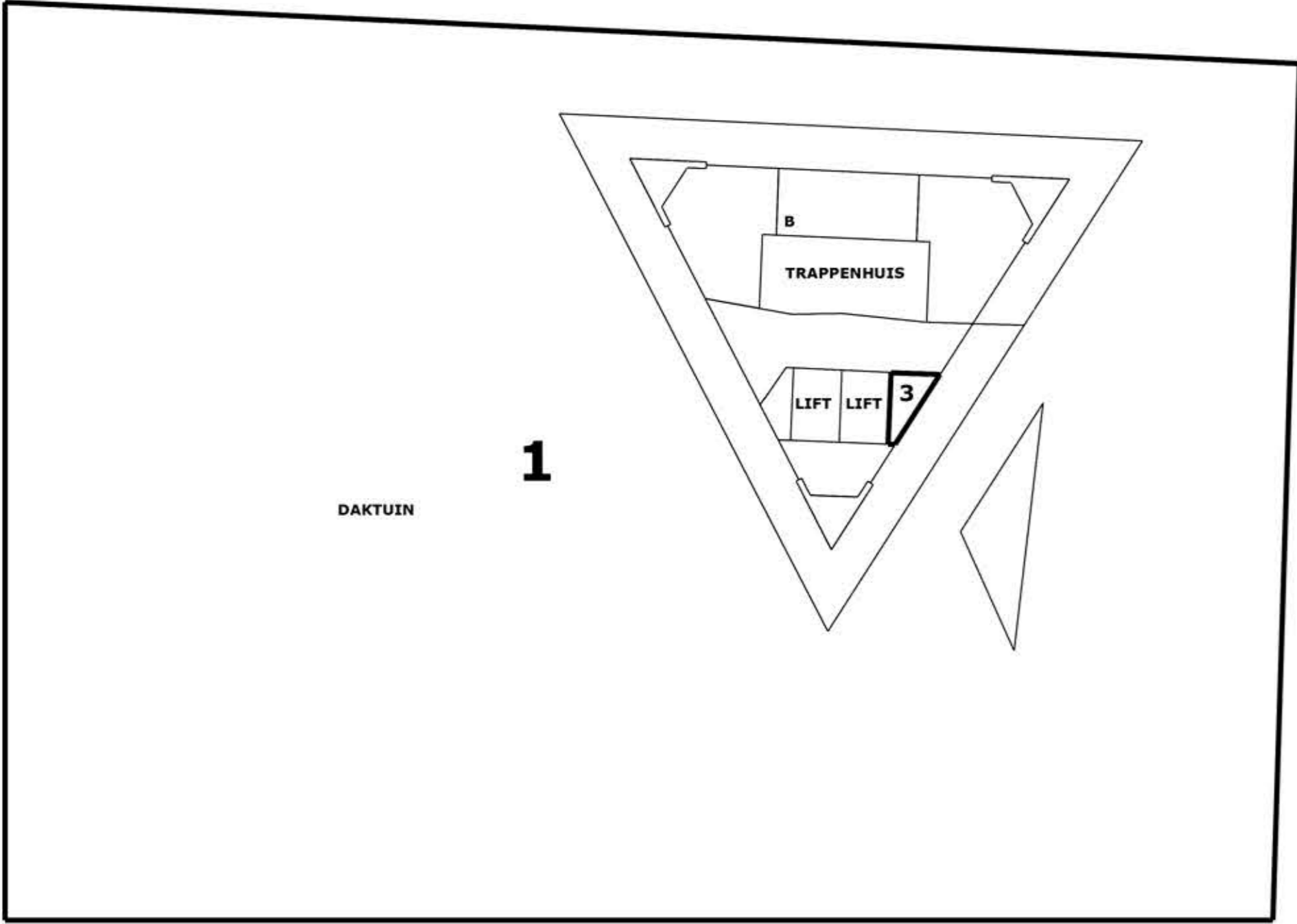

5e verdieping

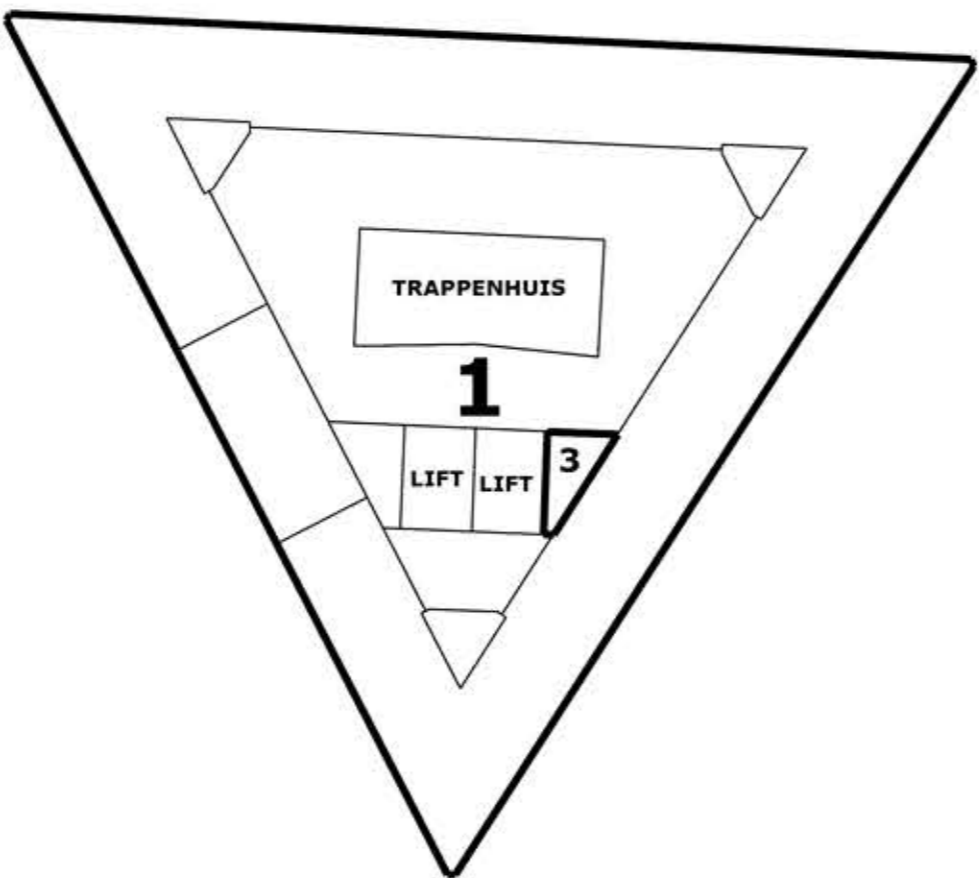

6e verdieping

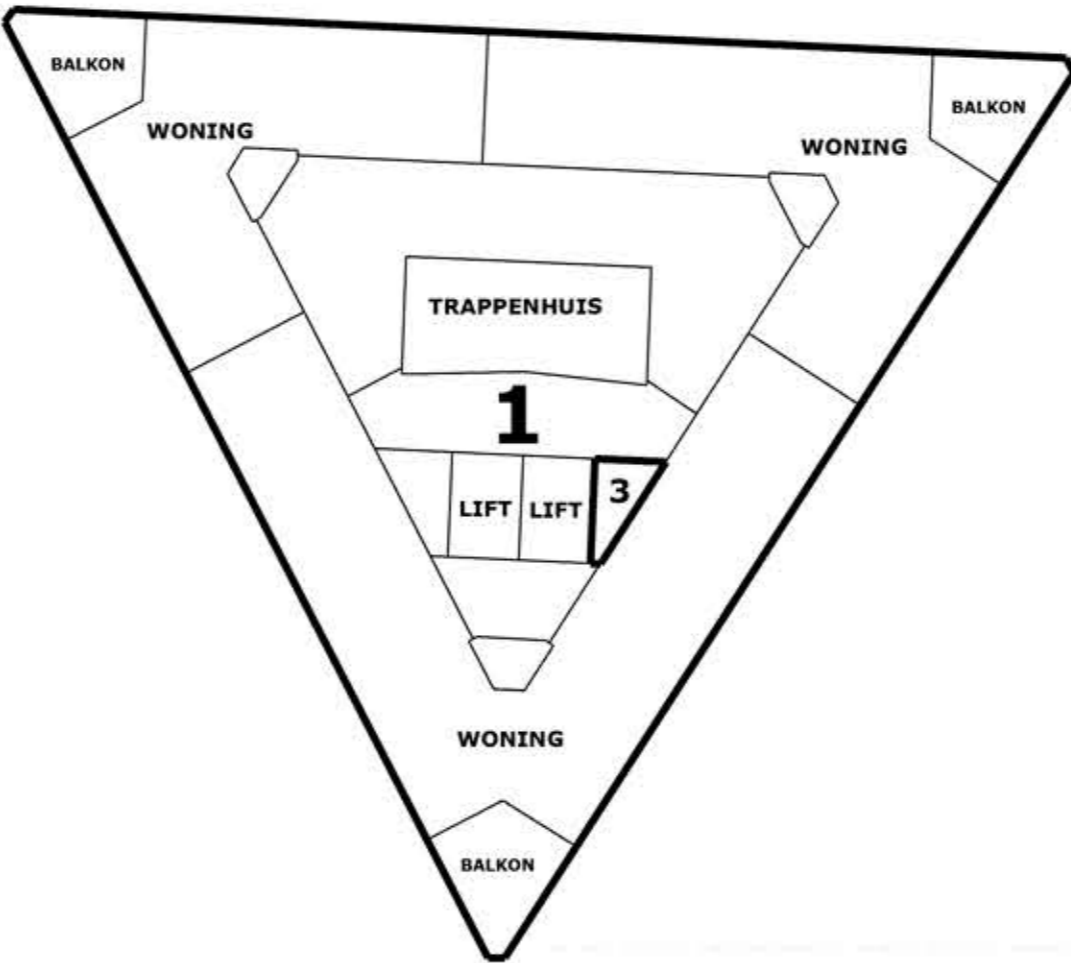

7e verdieping

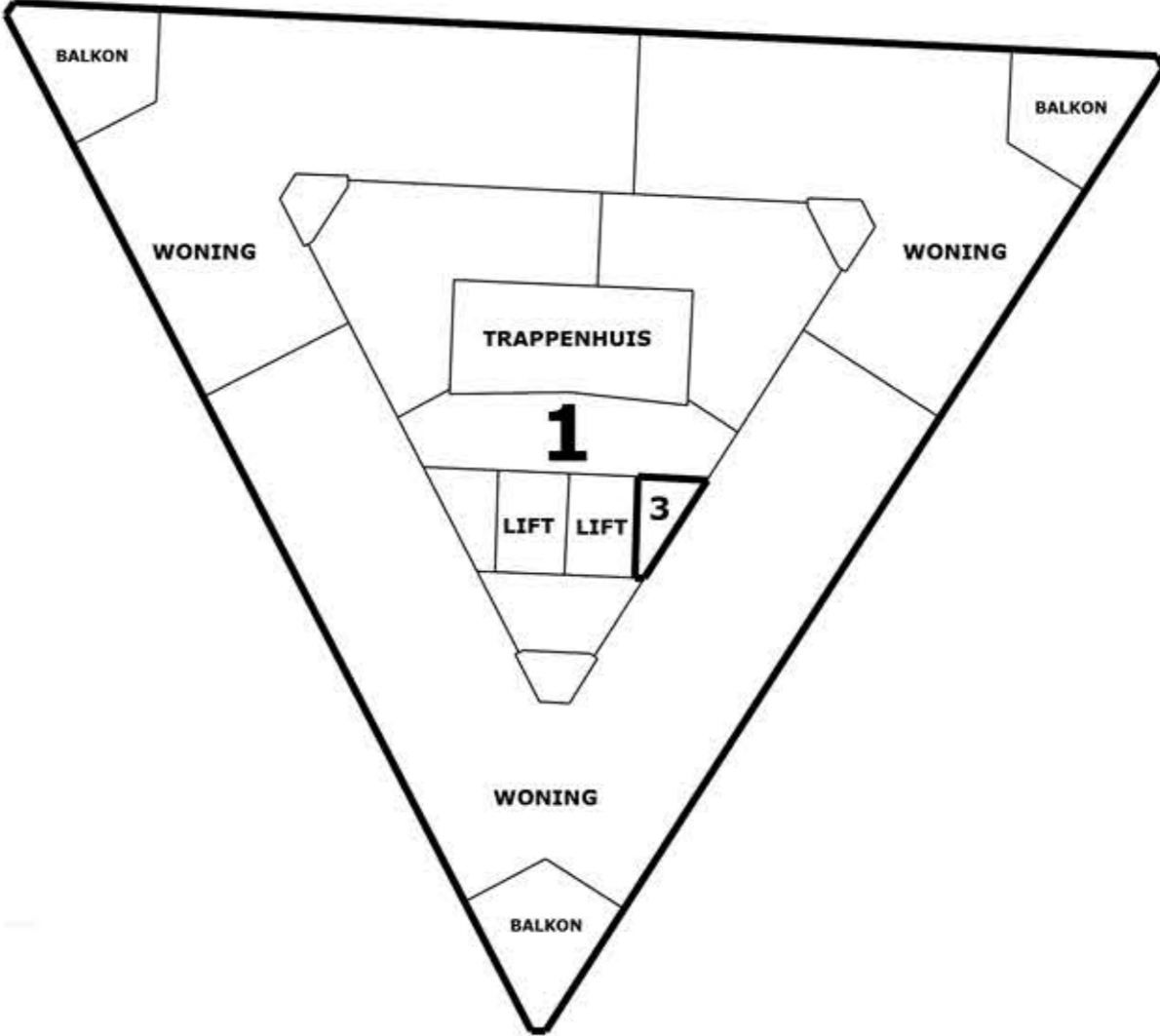

8e verdieping

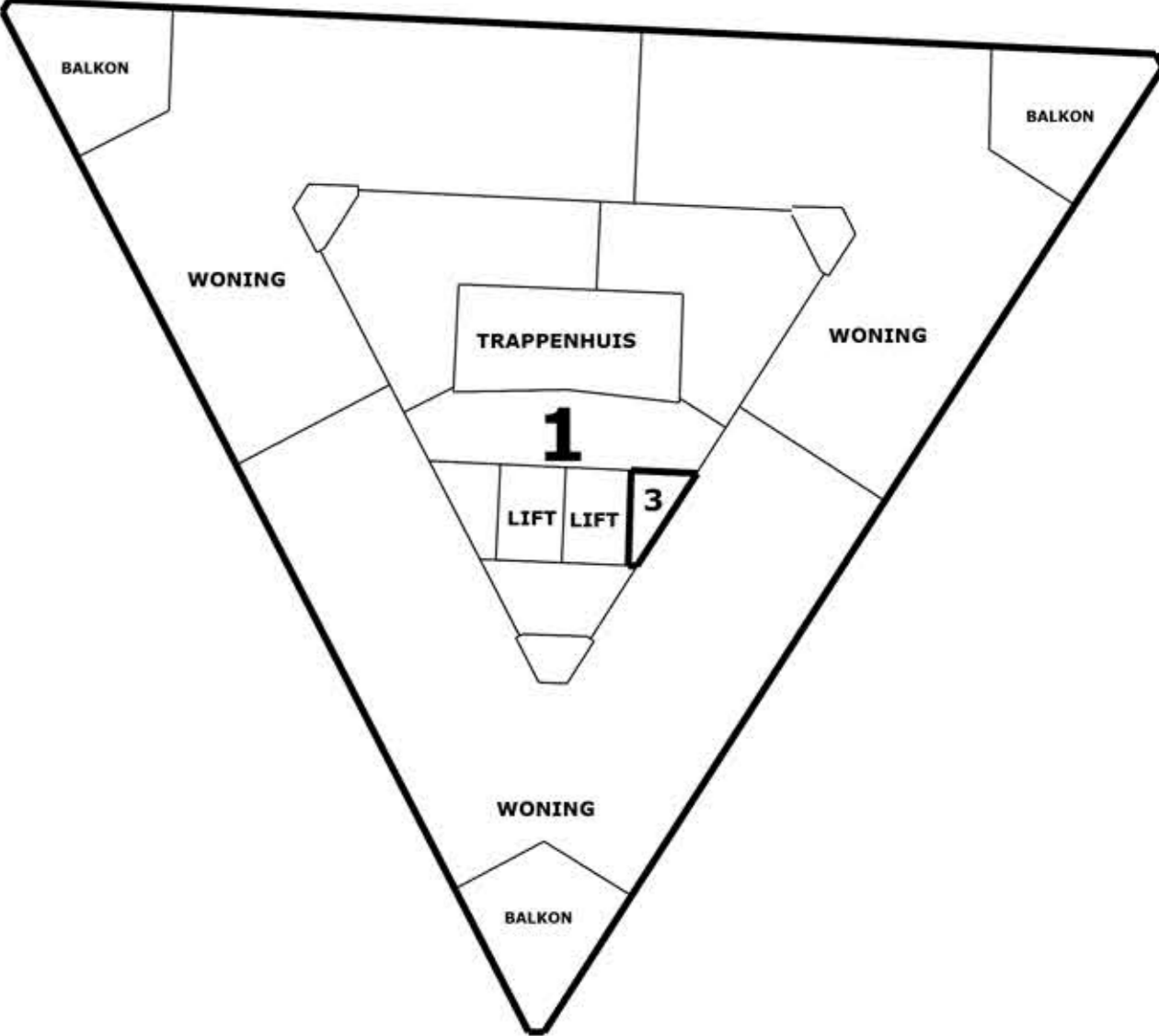

9e verdieping

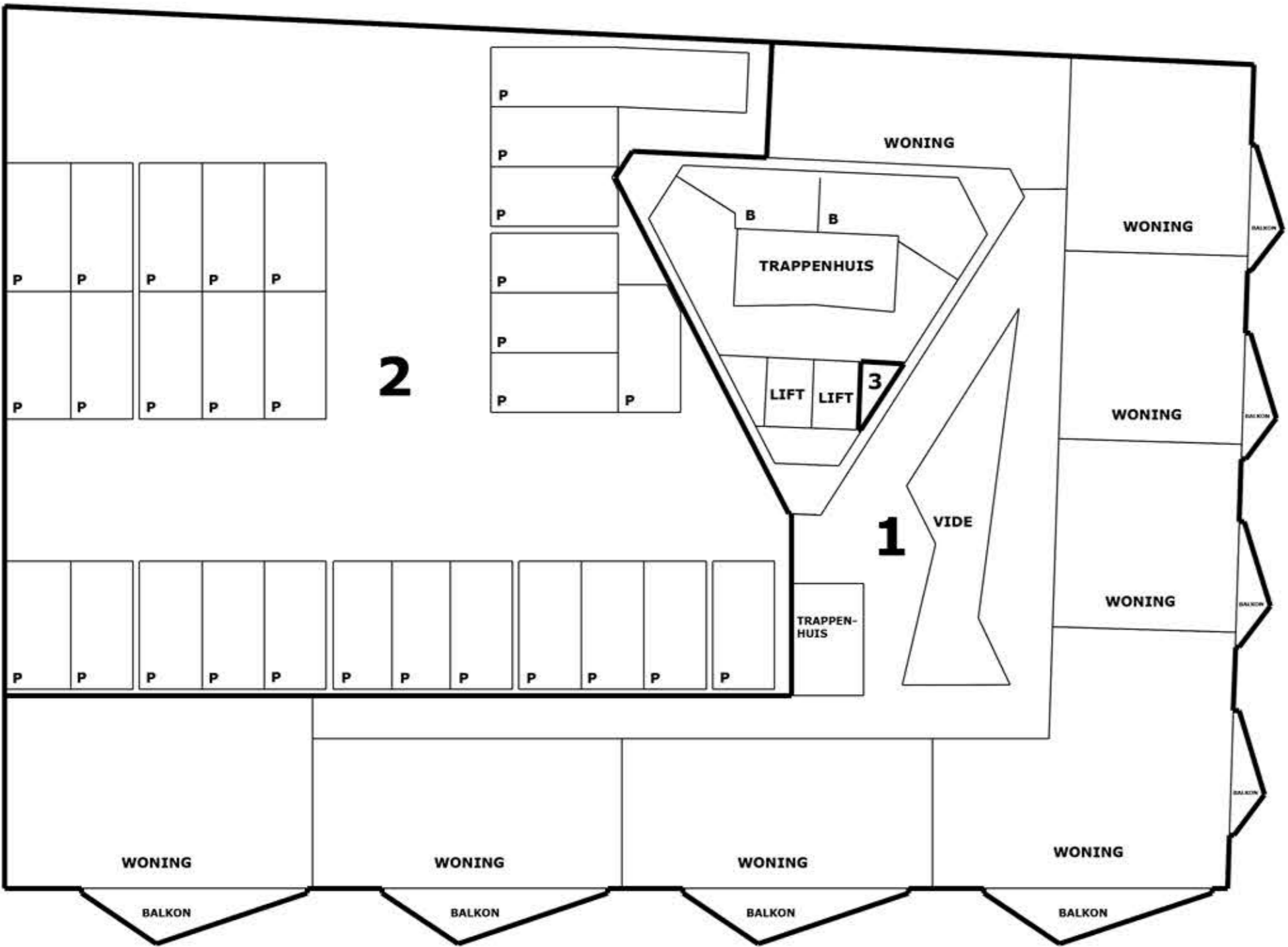

2e verdieping

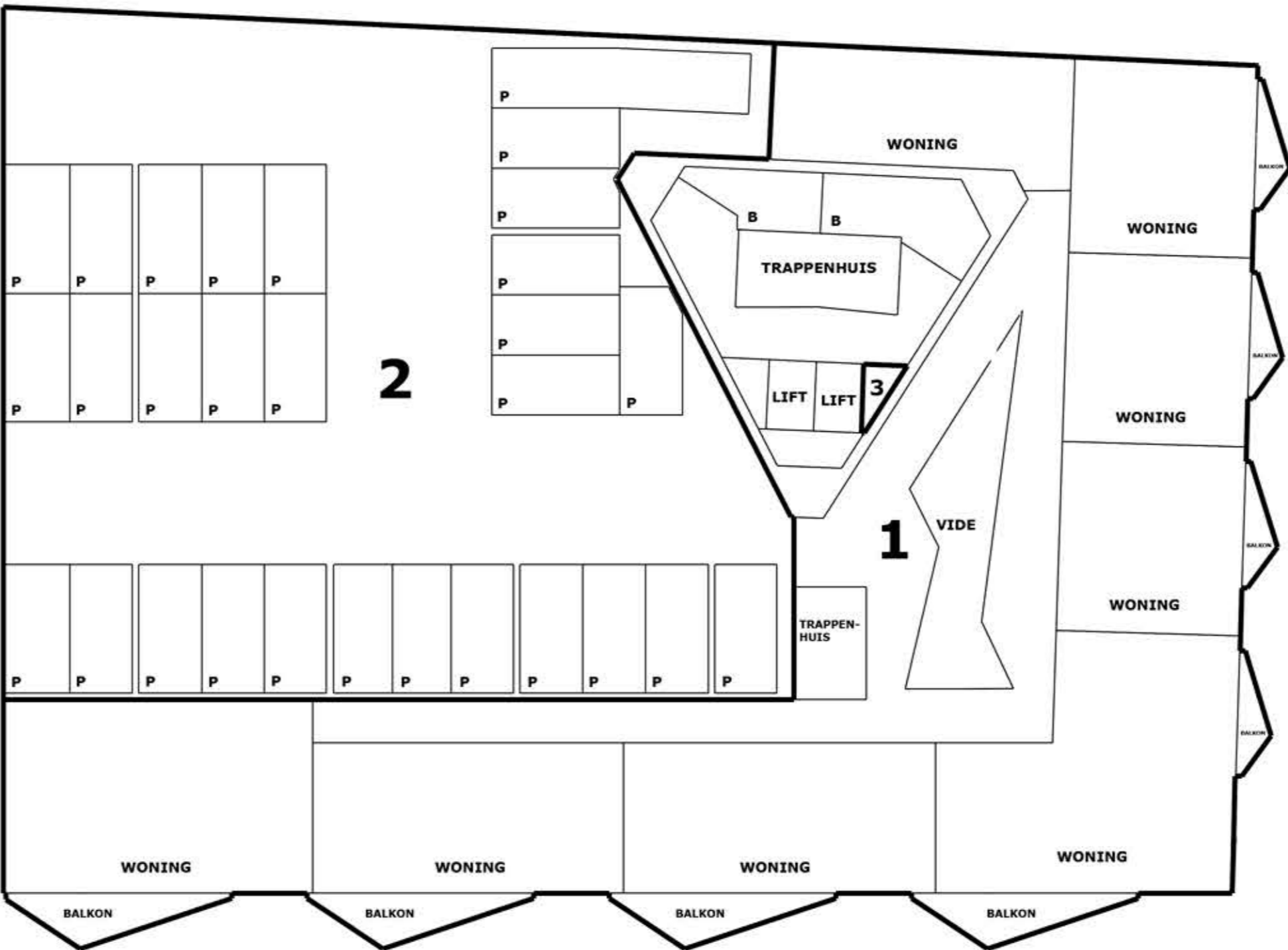

3e verdieping

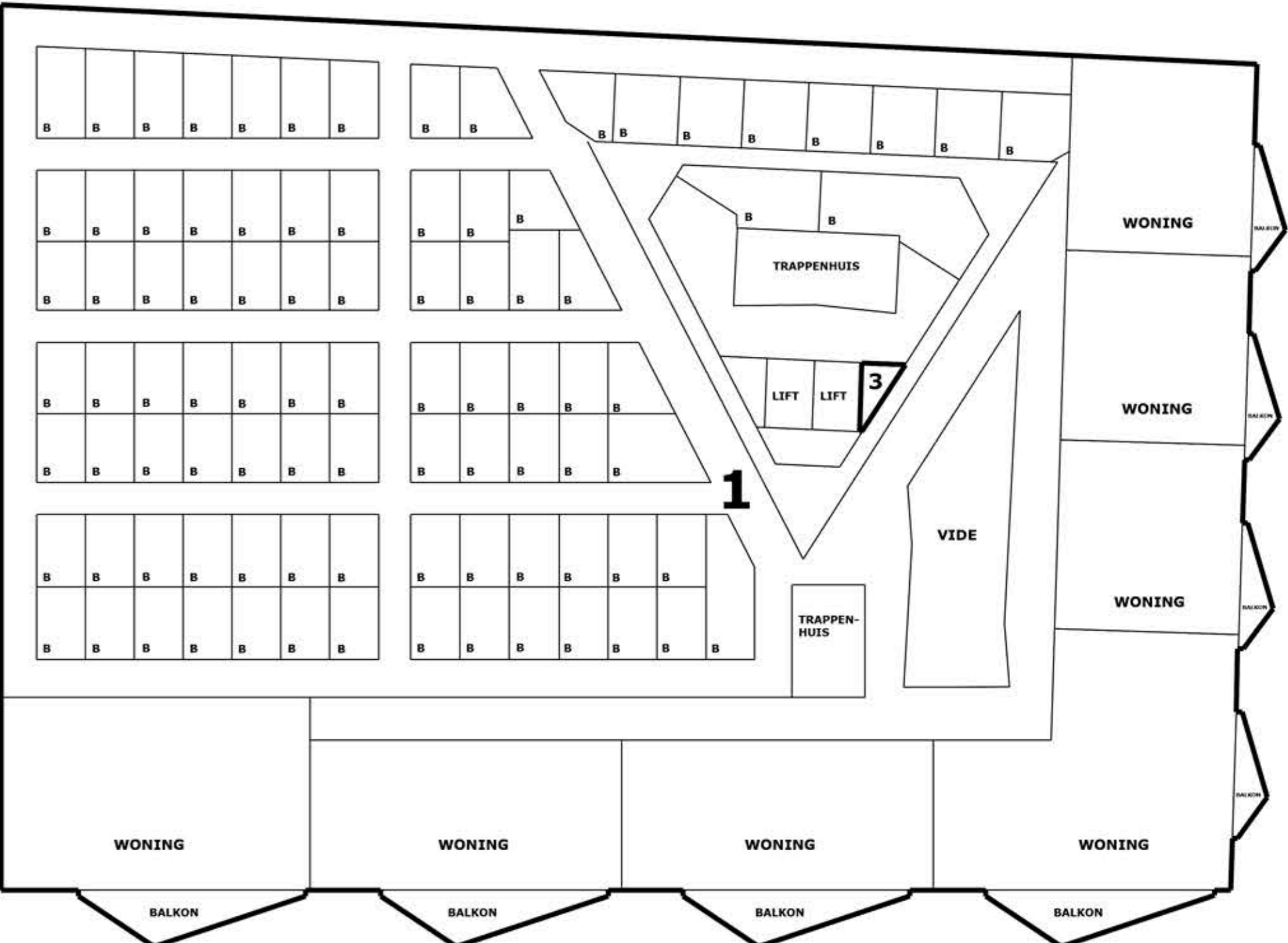

4e verdieping

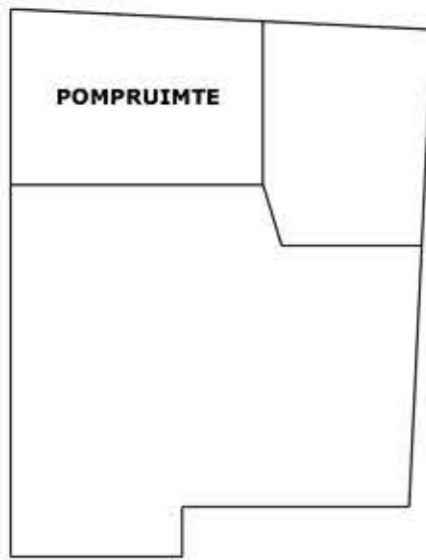

kelder

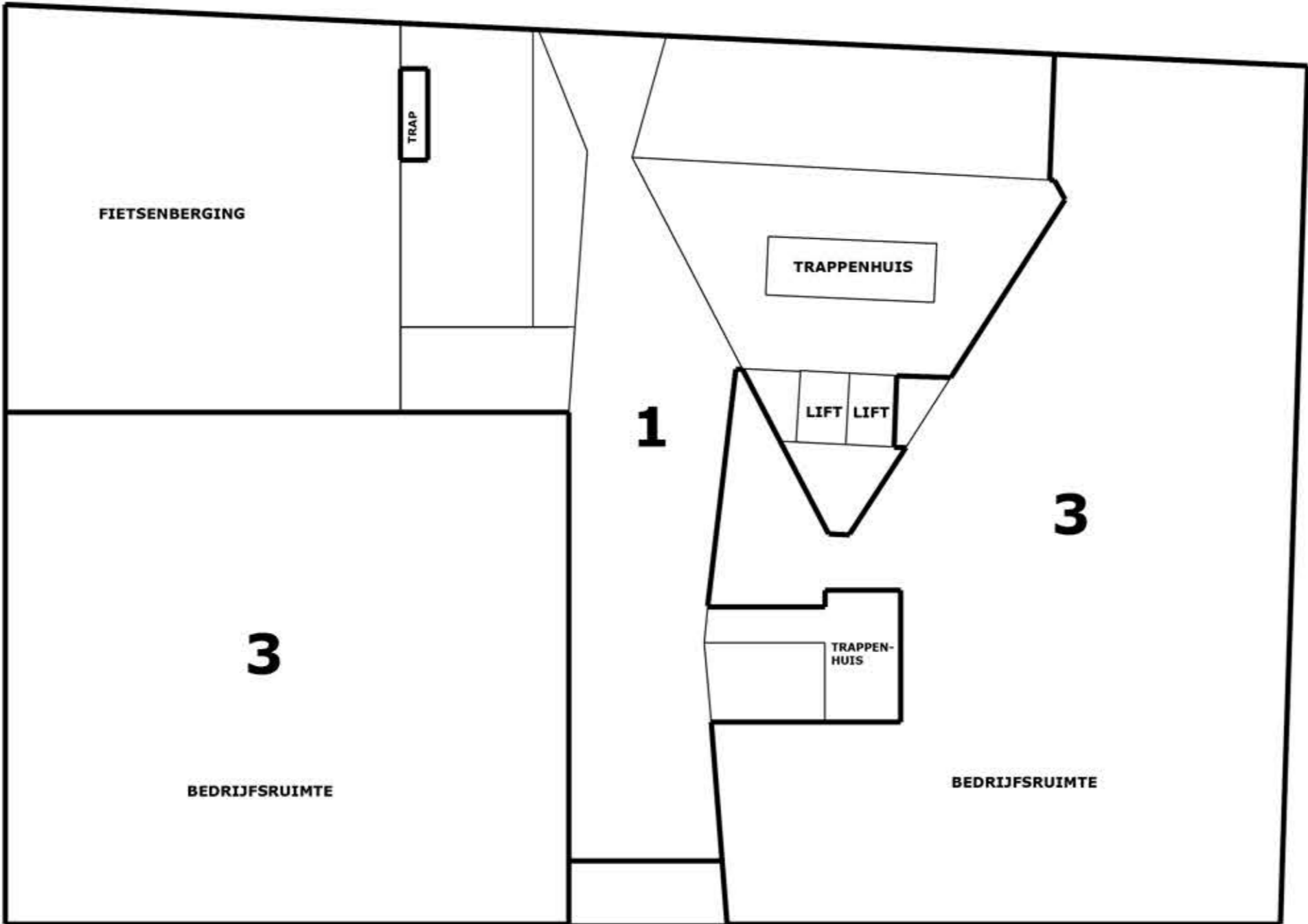

begane grond

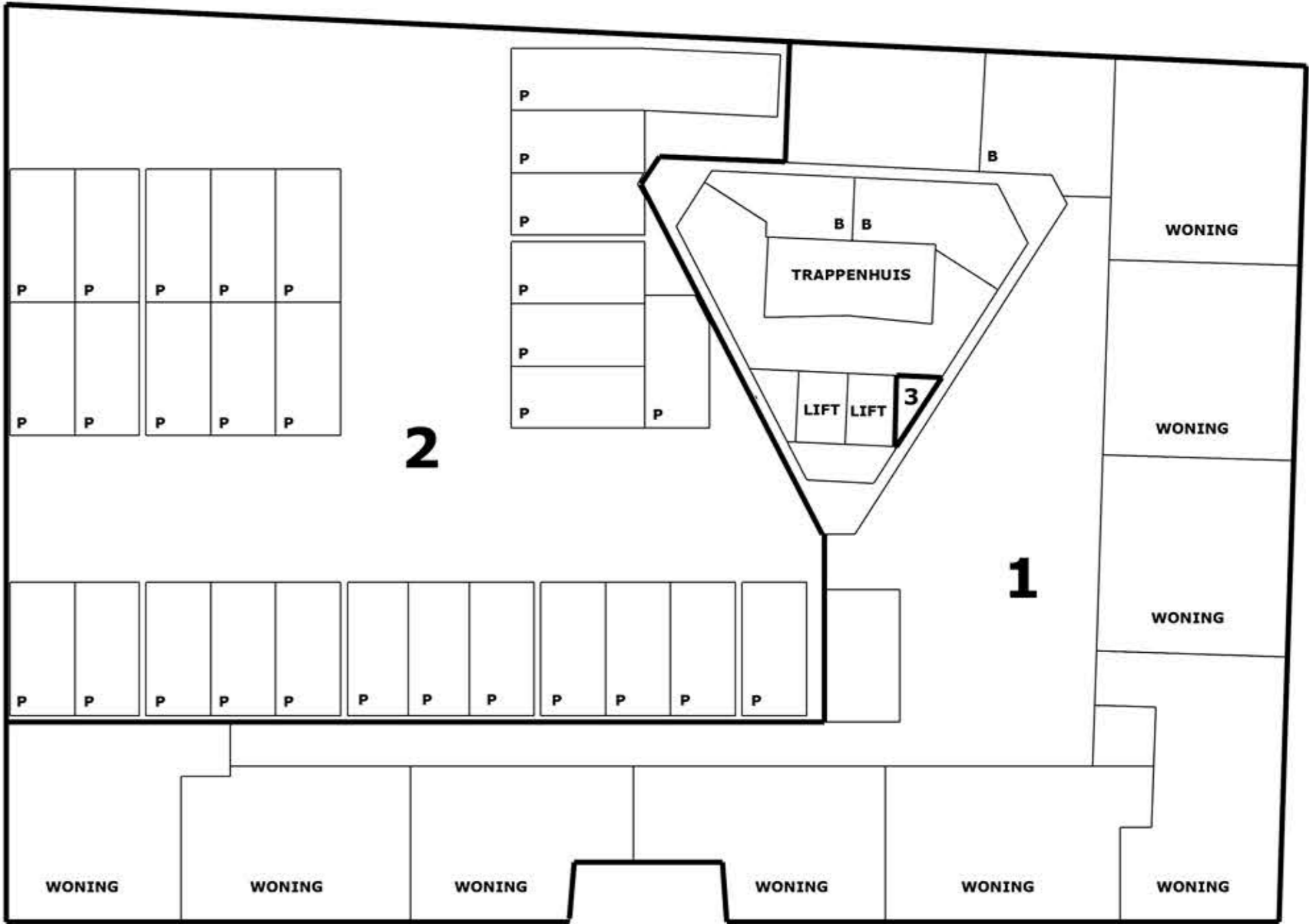

1e verdieping



SCHAAL 1 : 200



Voorgenomen splitsing in 3  
appartementenrechten van het  
kadastrale perceel gemeente  
ROTTERDAM sectie AH nr.

CONCEPT14112018

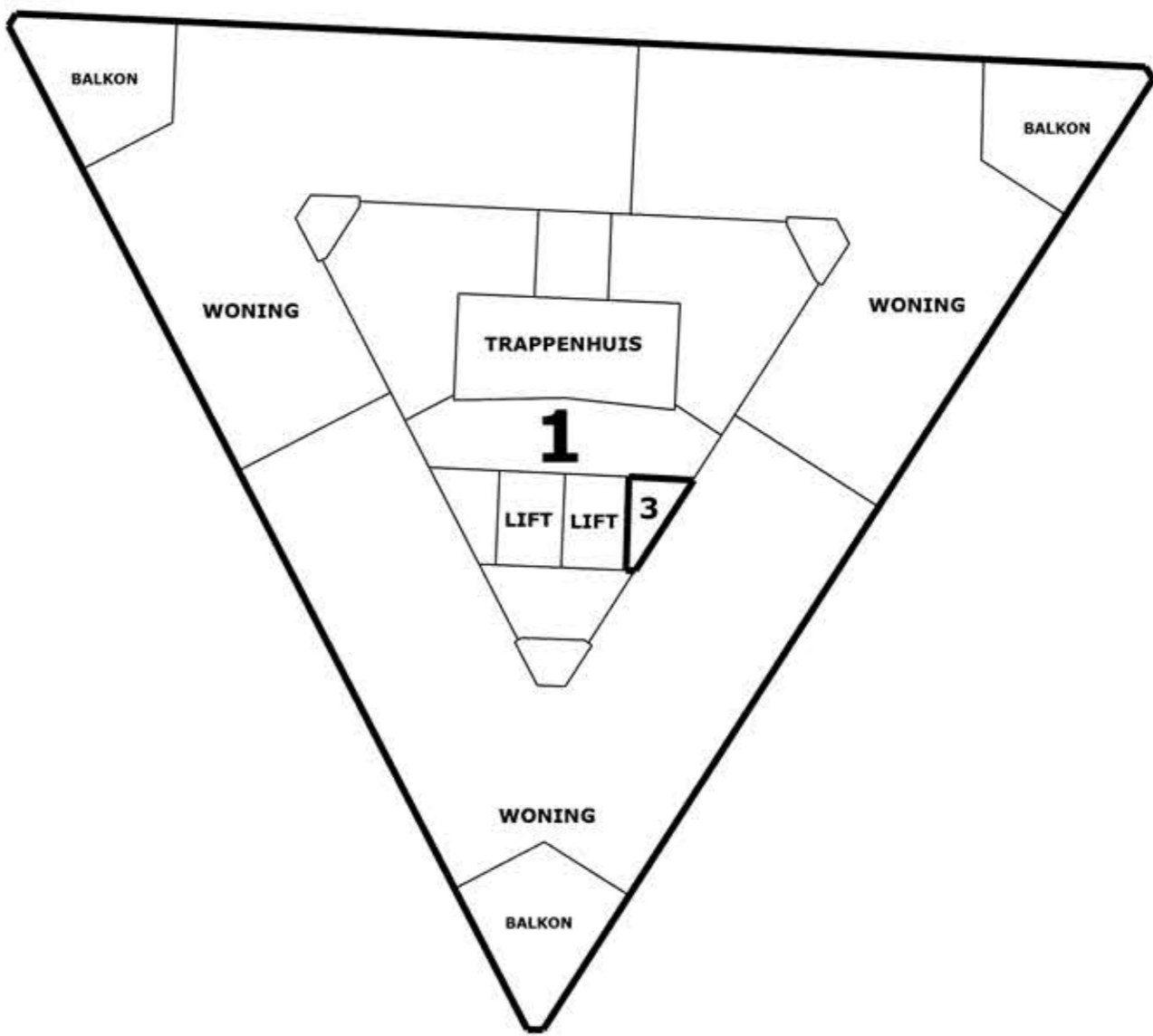

25e verdieping

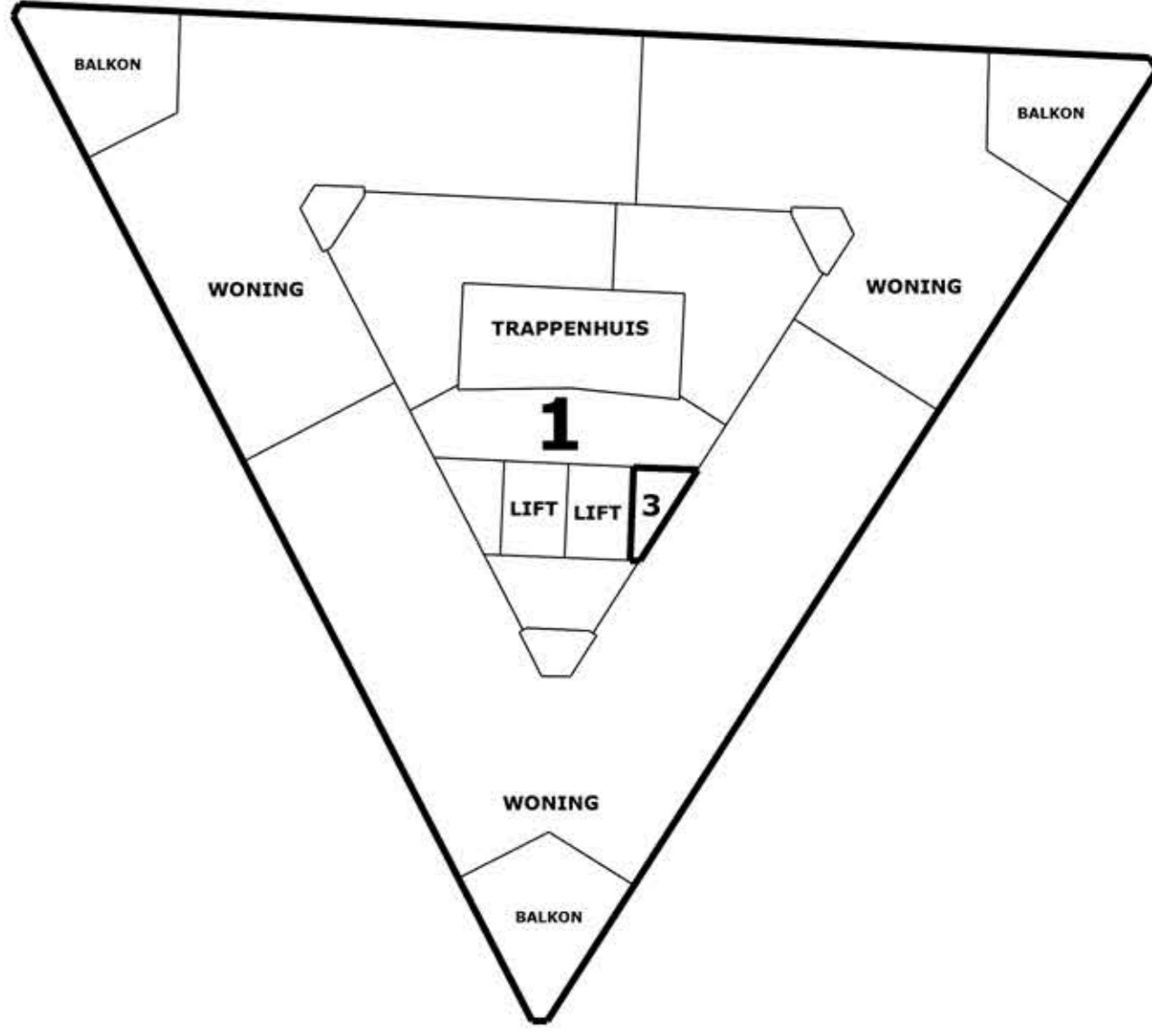

26e verdieping

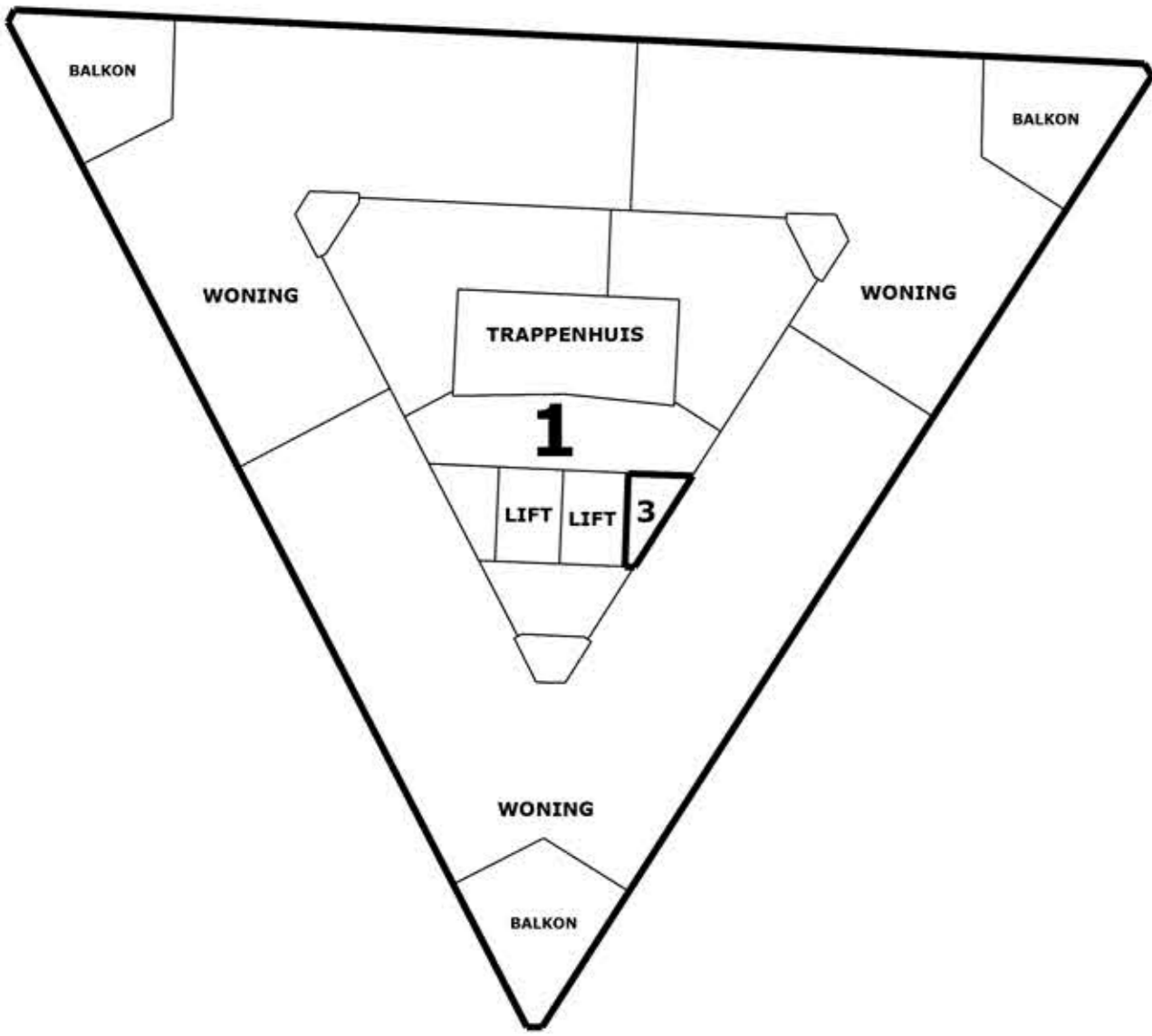

20e verdieping

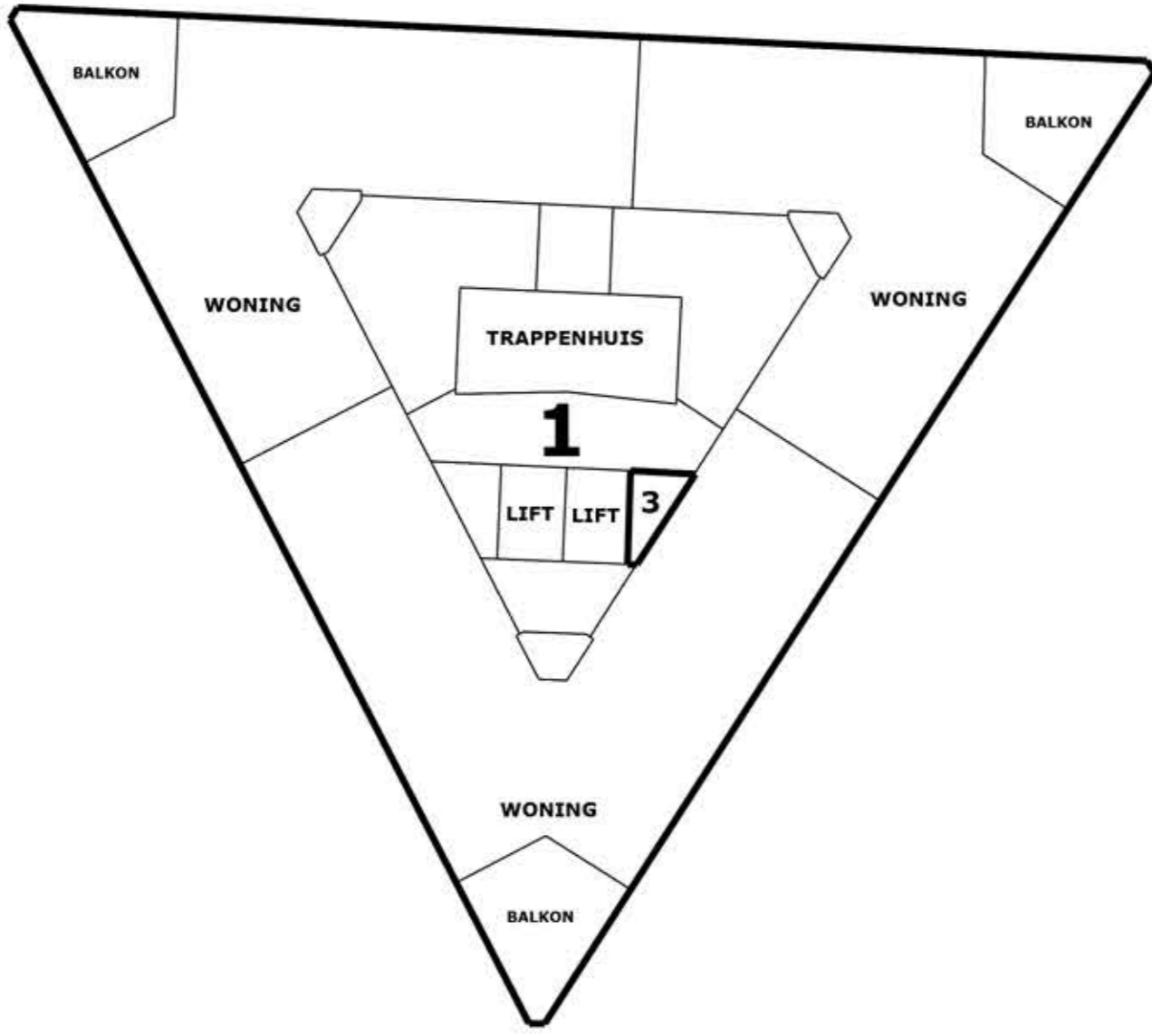

21e verdieping

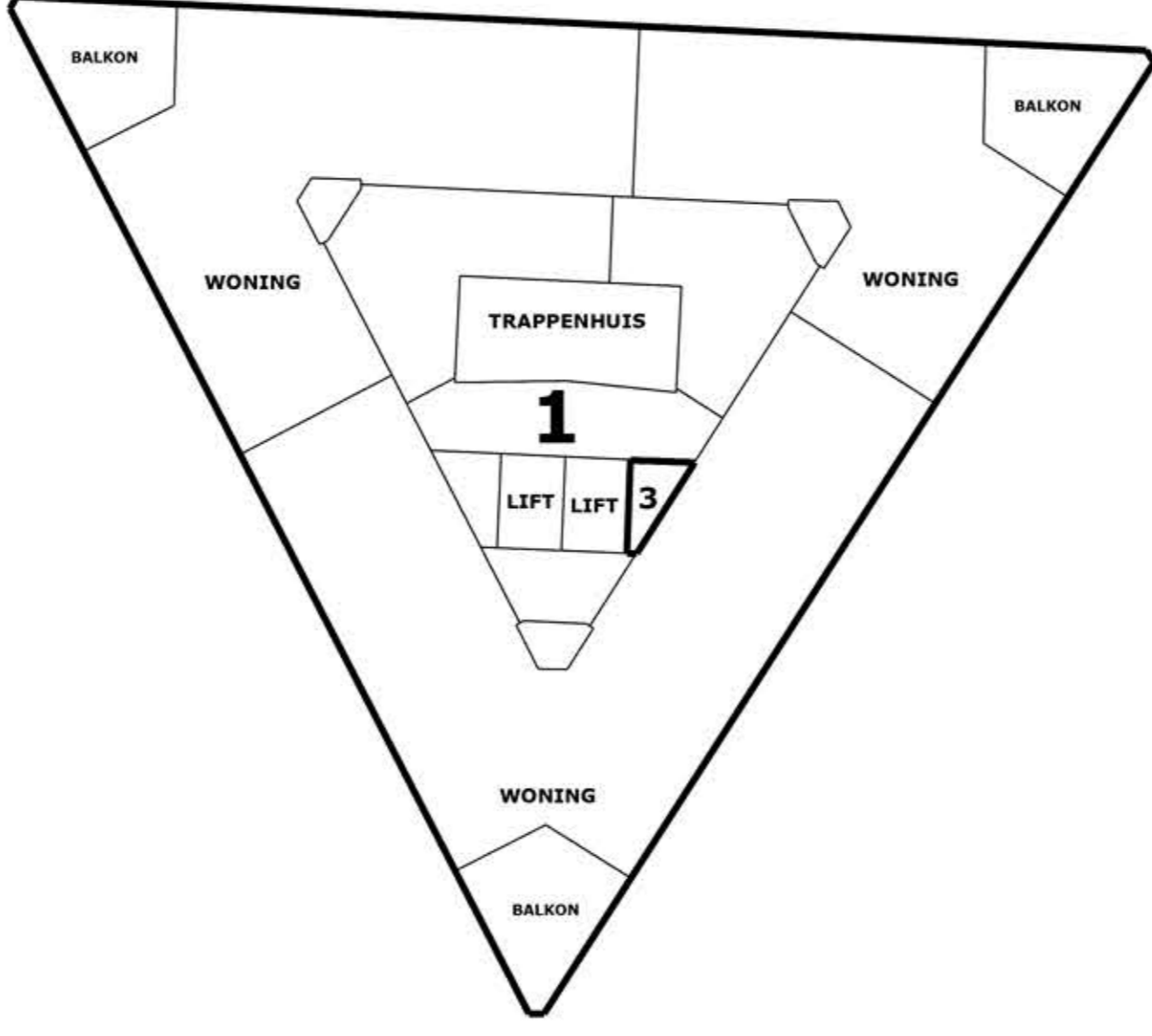

22e verdieping

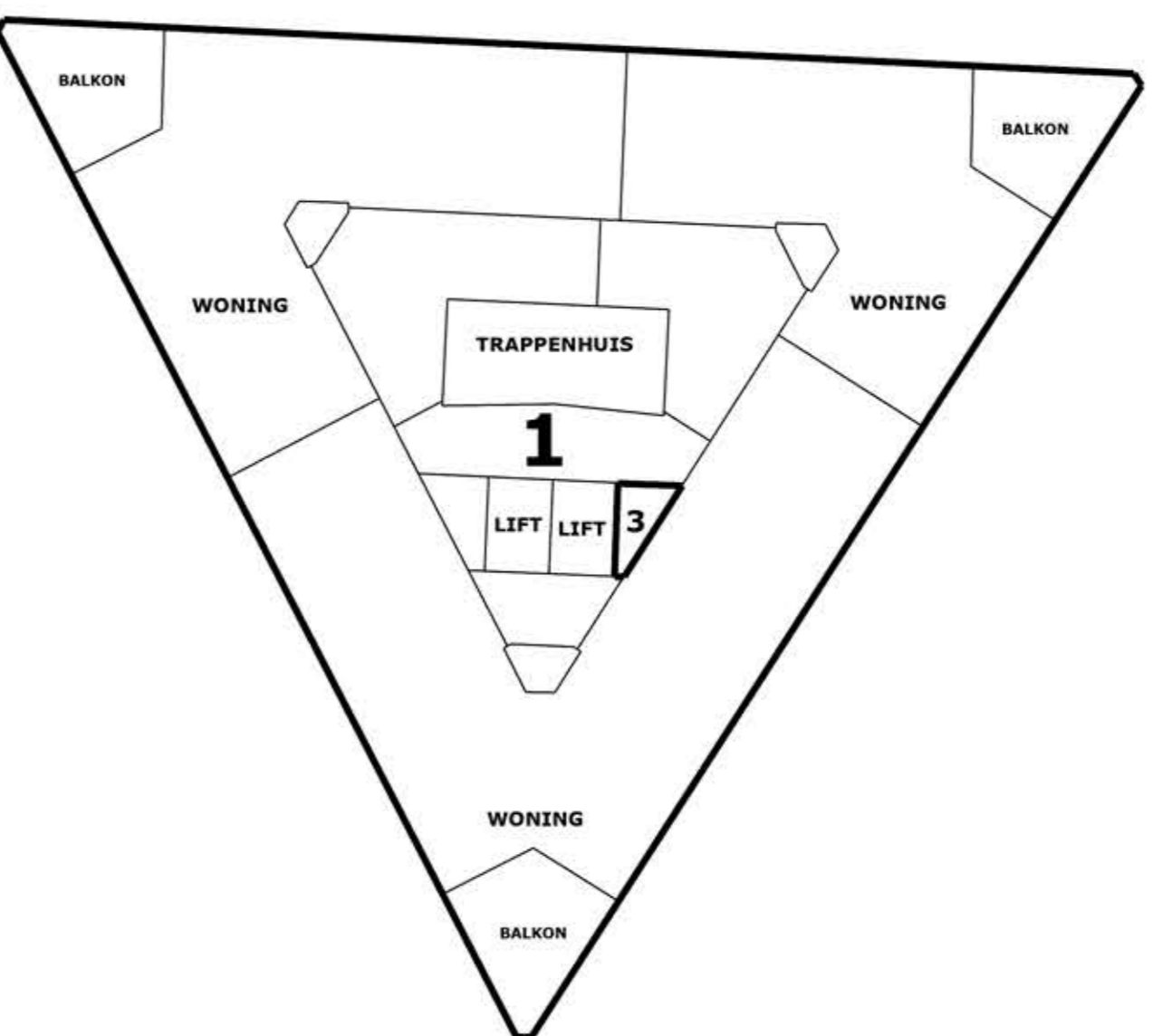

23e verdieping

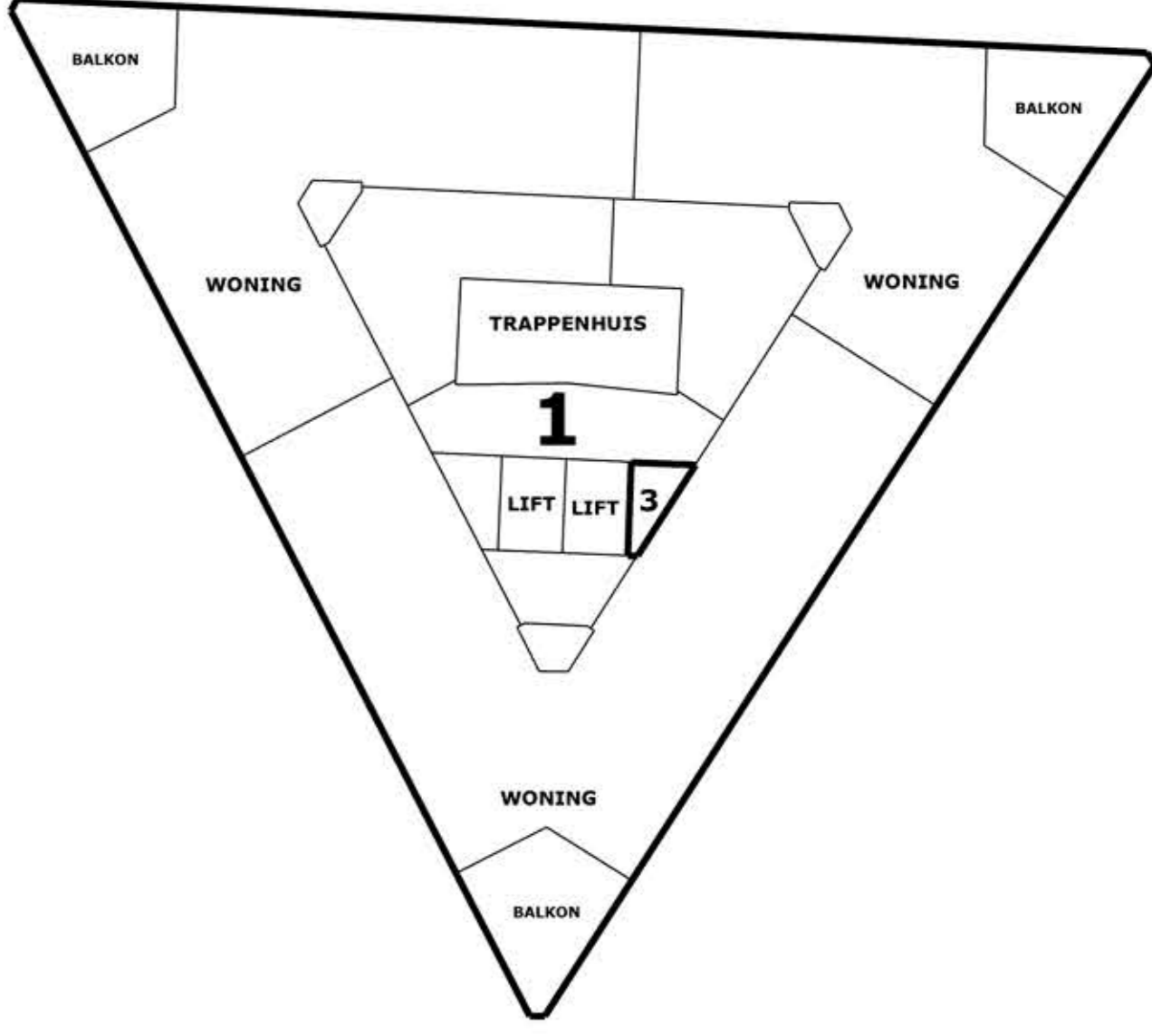

24e verdieping

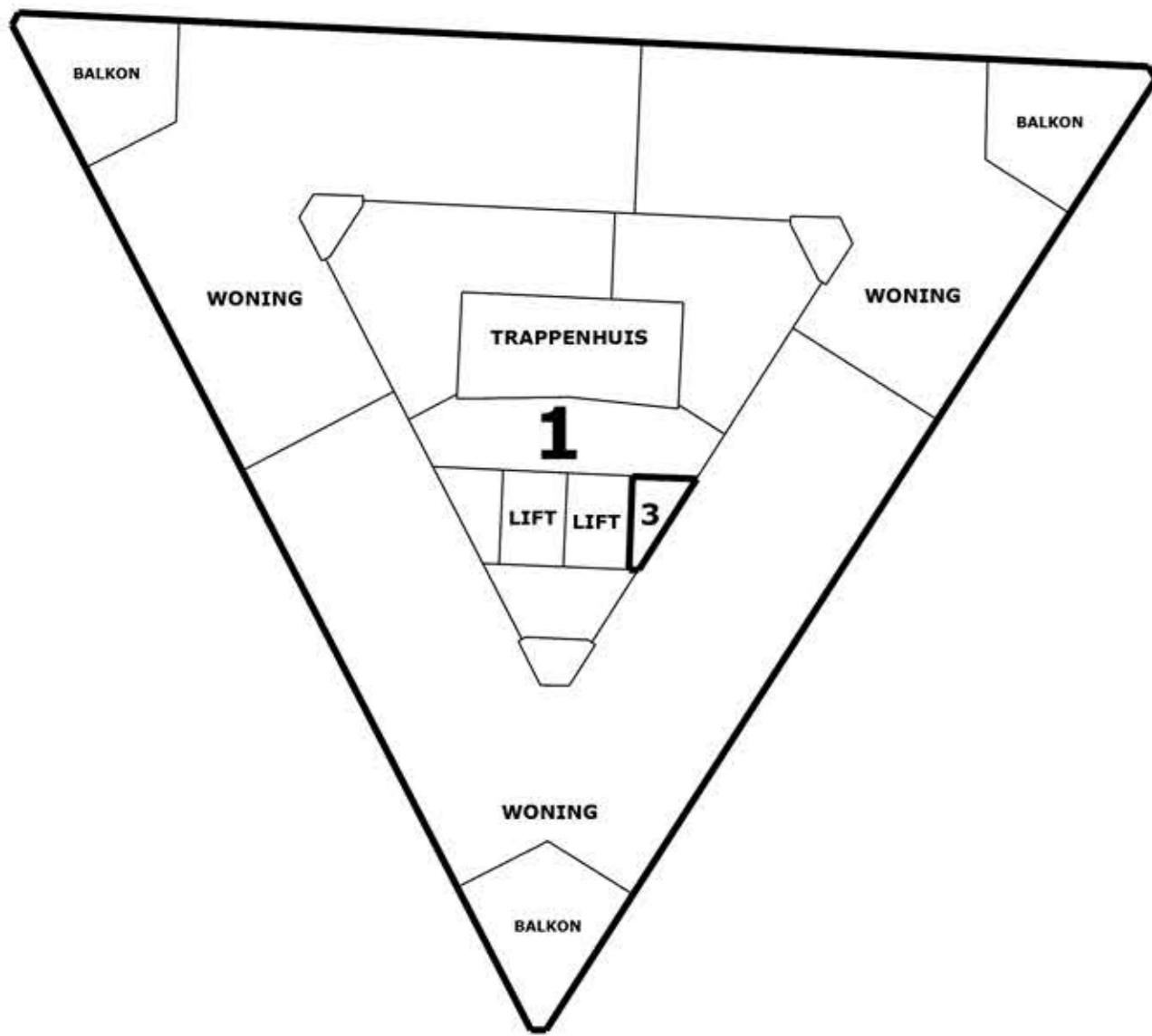

15e verdieping

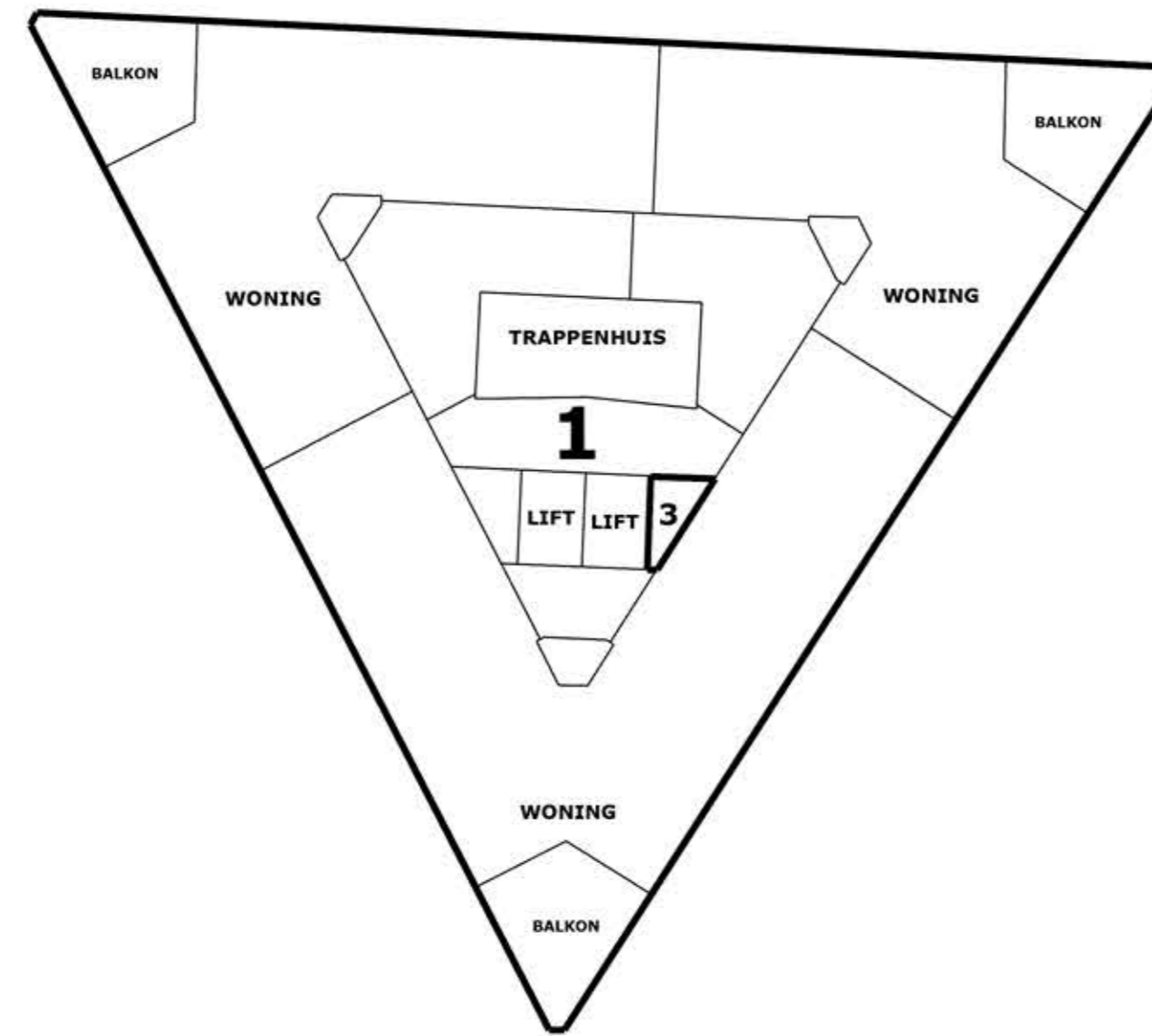

16e verdieping

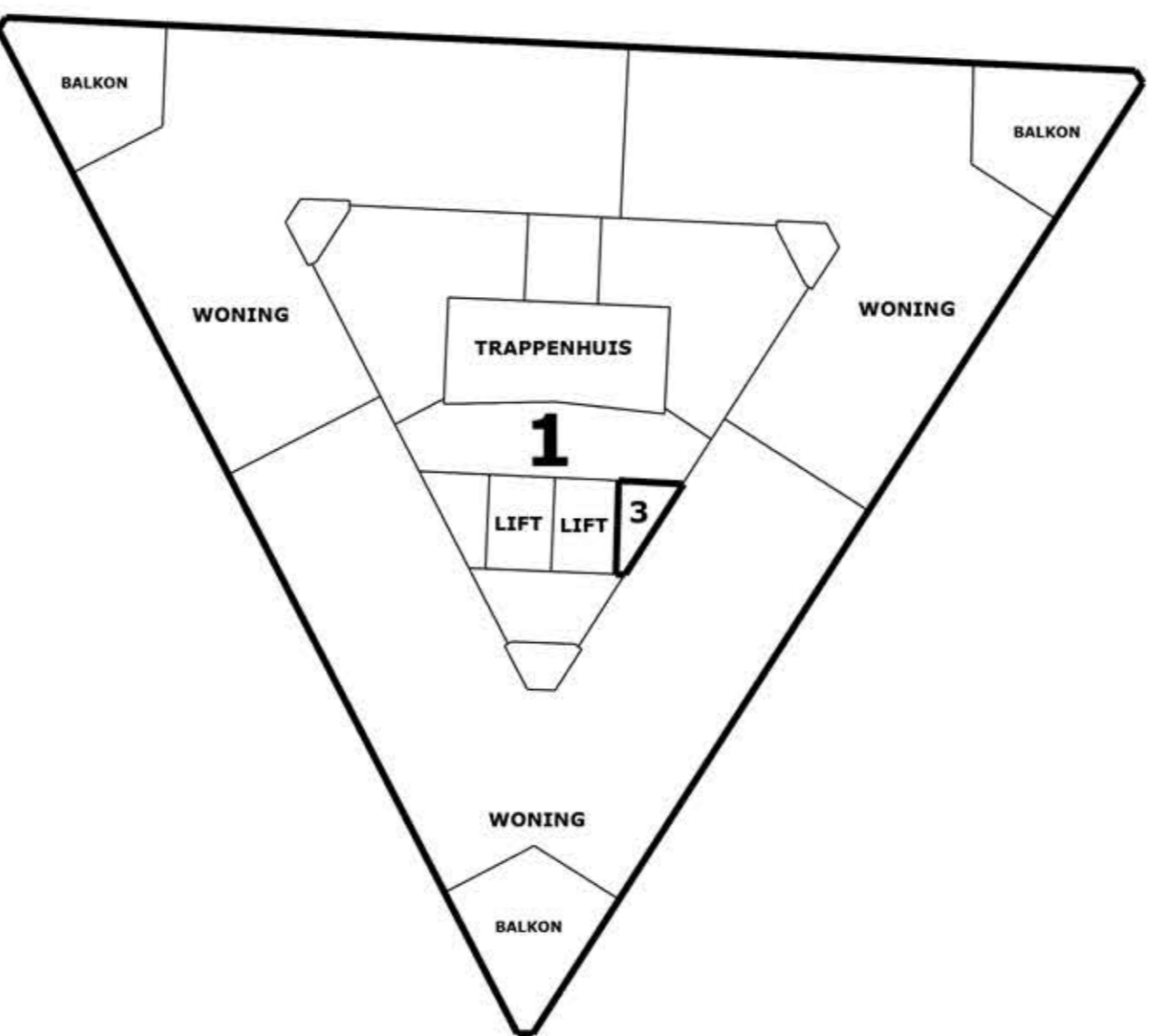

17e verdieping

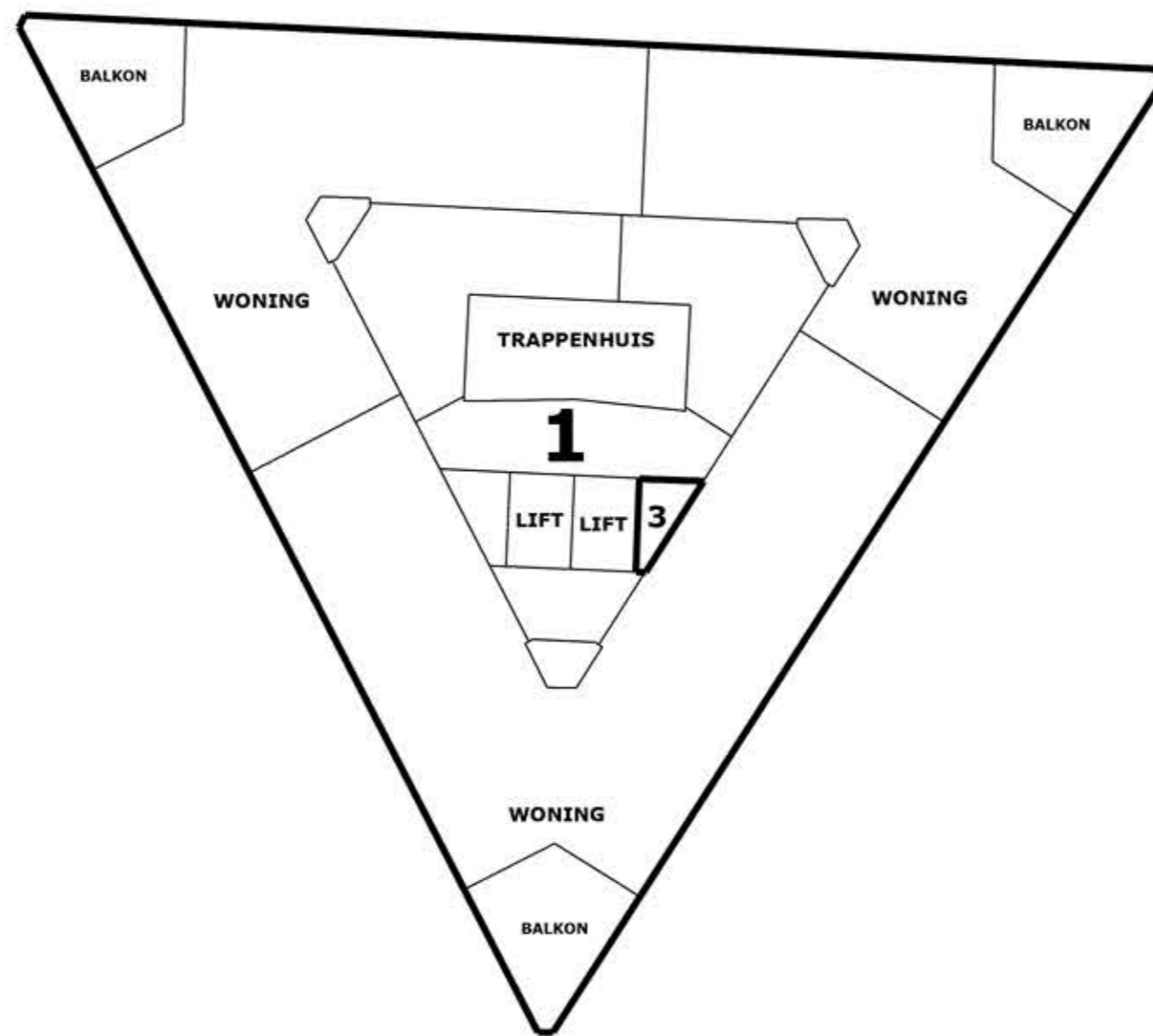

18e verdieping

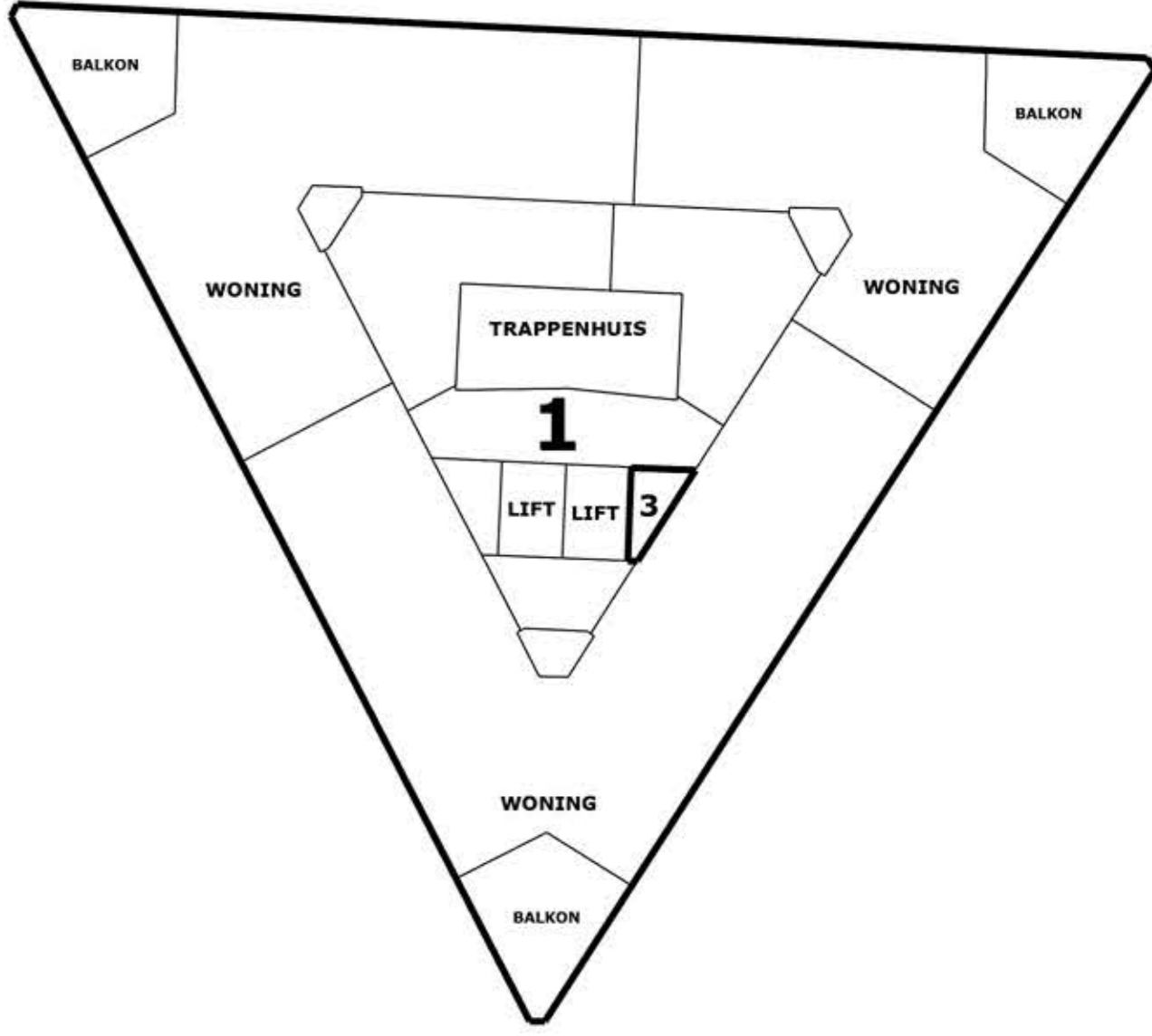

19e verdieping

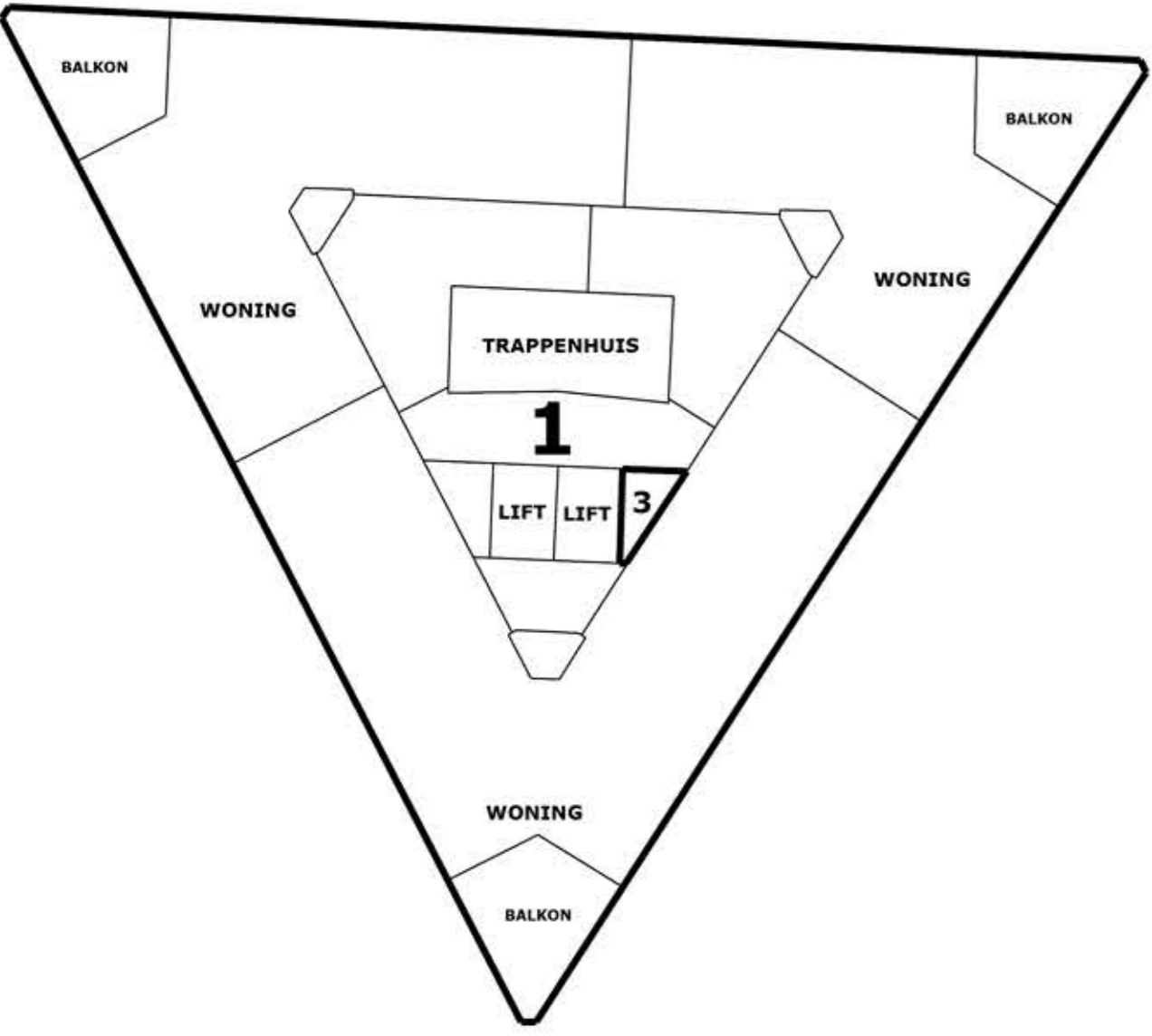

10e verdieping

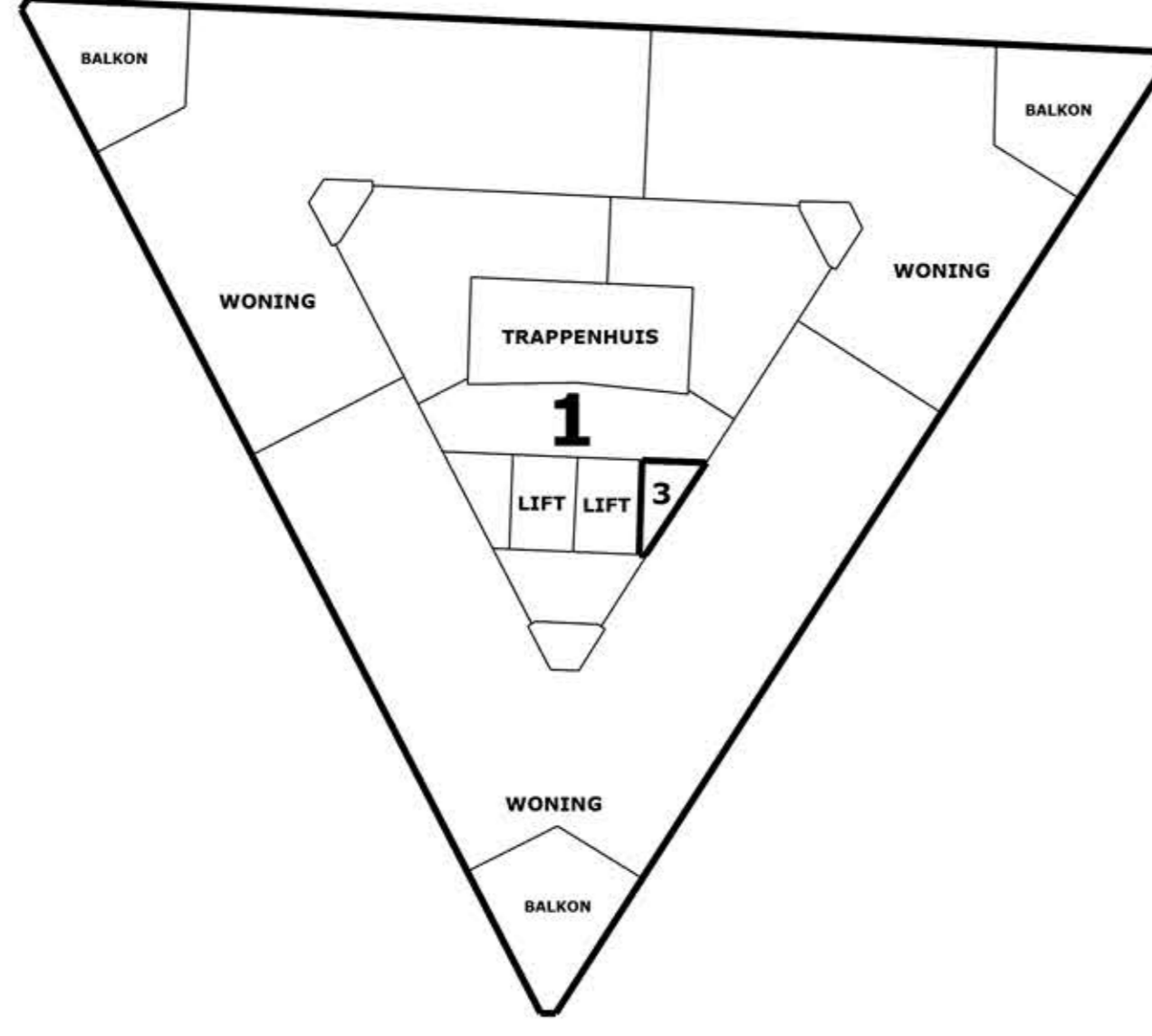

11e verdieping

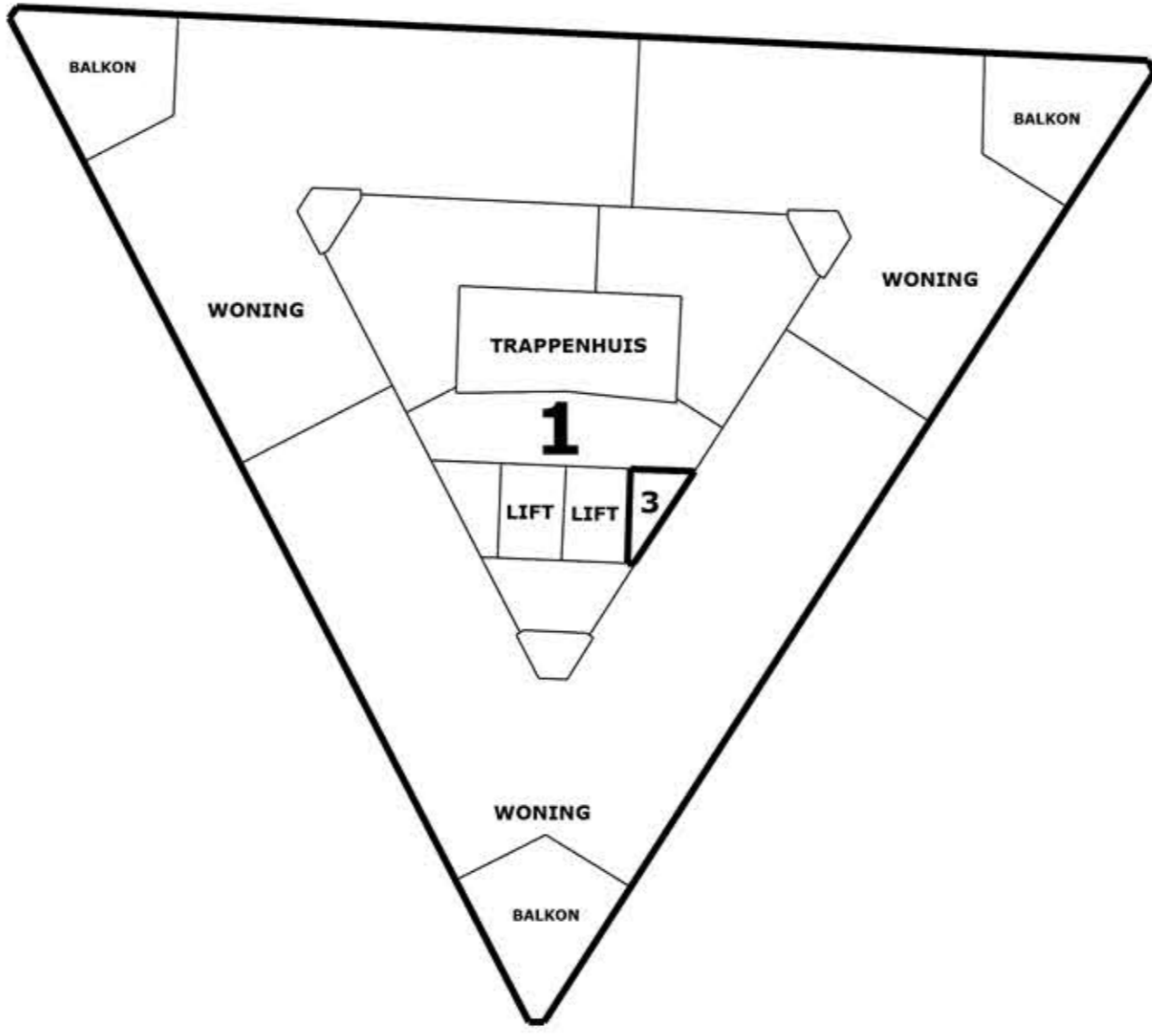

12e verdieping

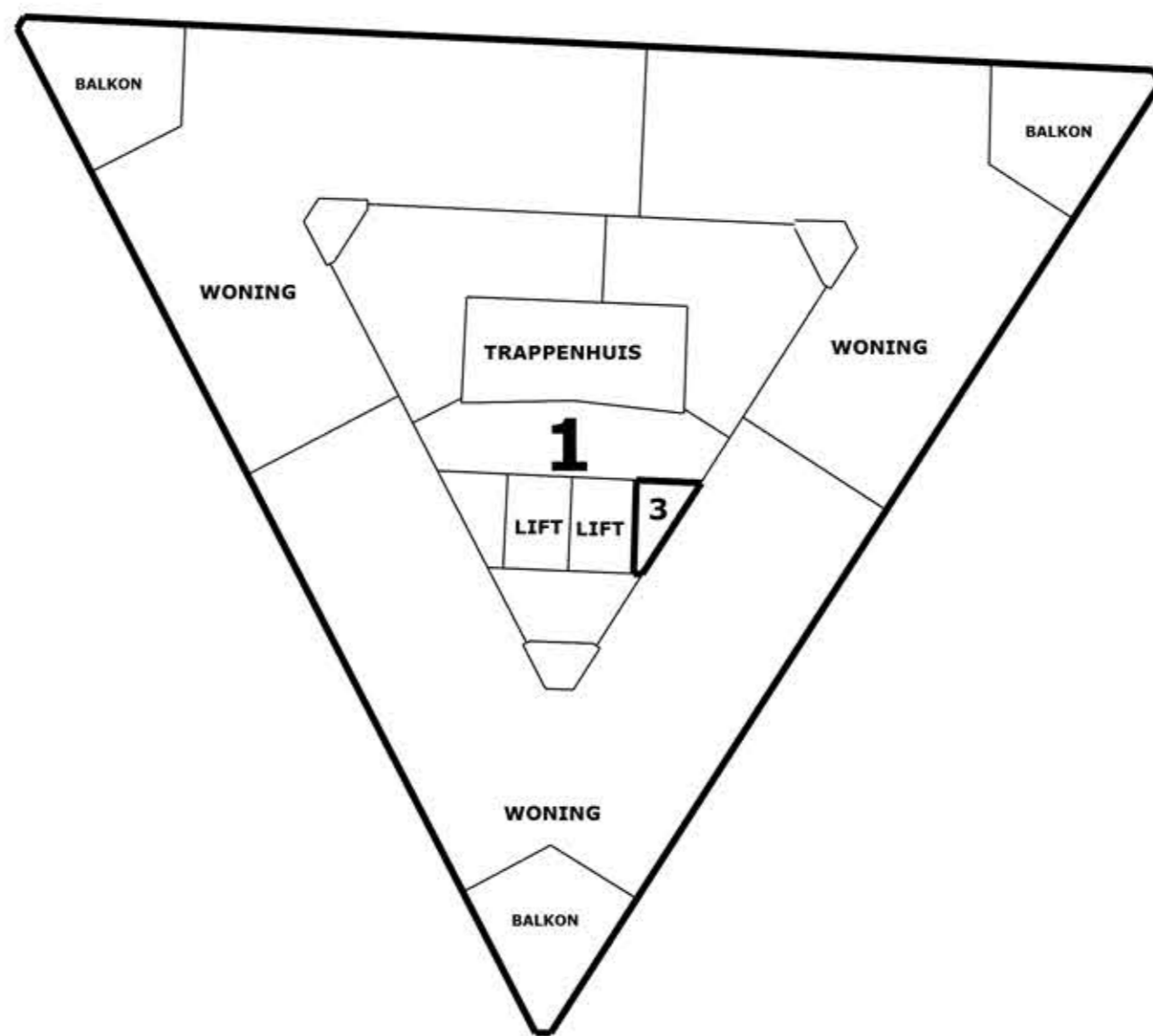

13e verdieping

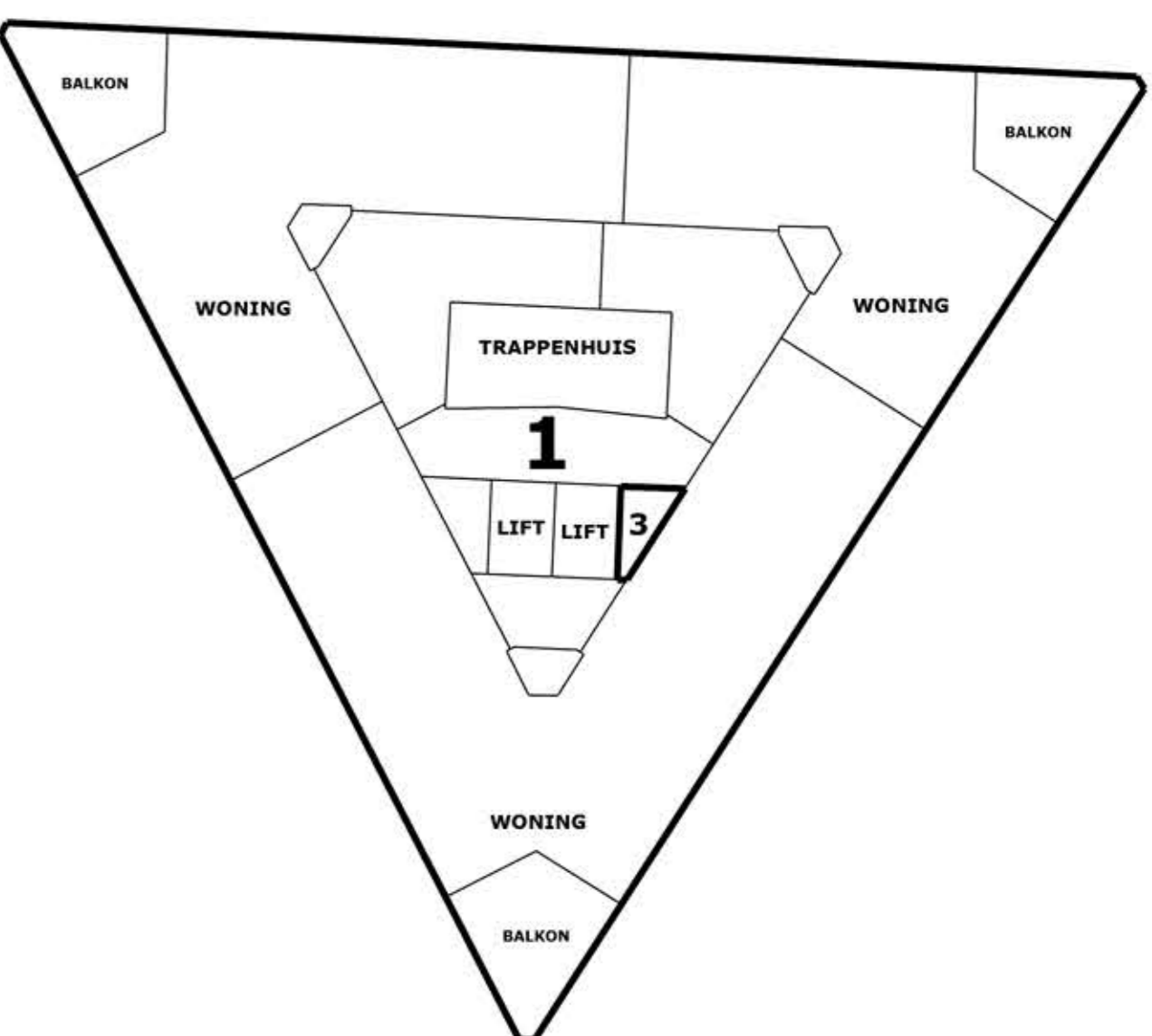

14e verdieping



APPARTEMENTSTEKENING  
CASANOVA  
ROTTERDAM

(Blad 3 van 3)

SCHAAL 1 : 200



Voorgenomen splitsing in 3  
appartementenrechten van het  
kadastrale perceel gemeente  
ROTTERDAM sectie AH nr.

CONCEPT14112018

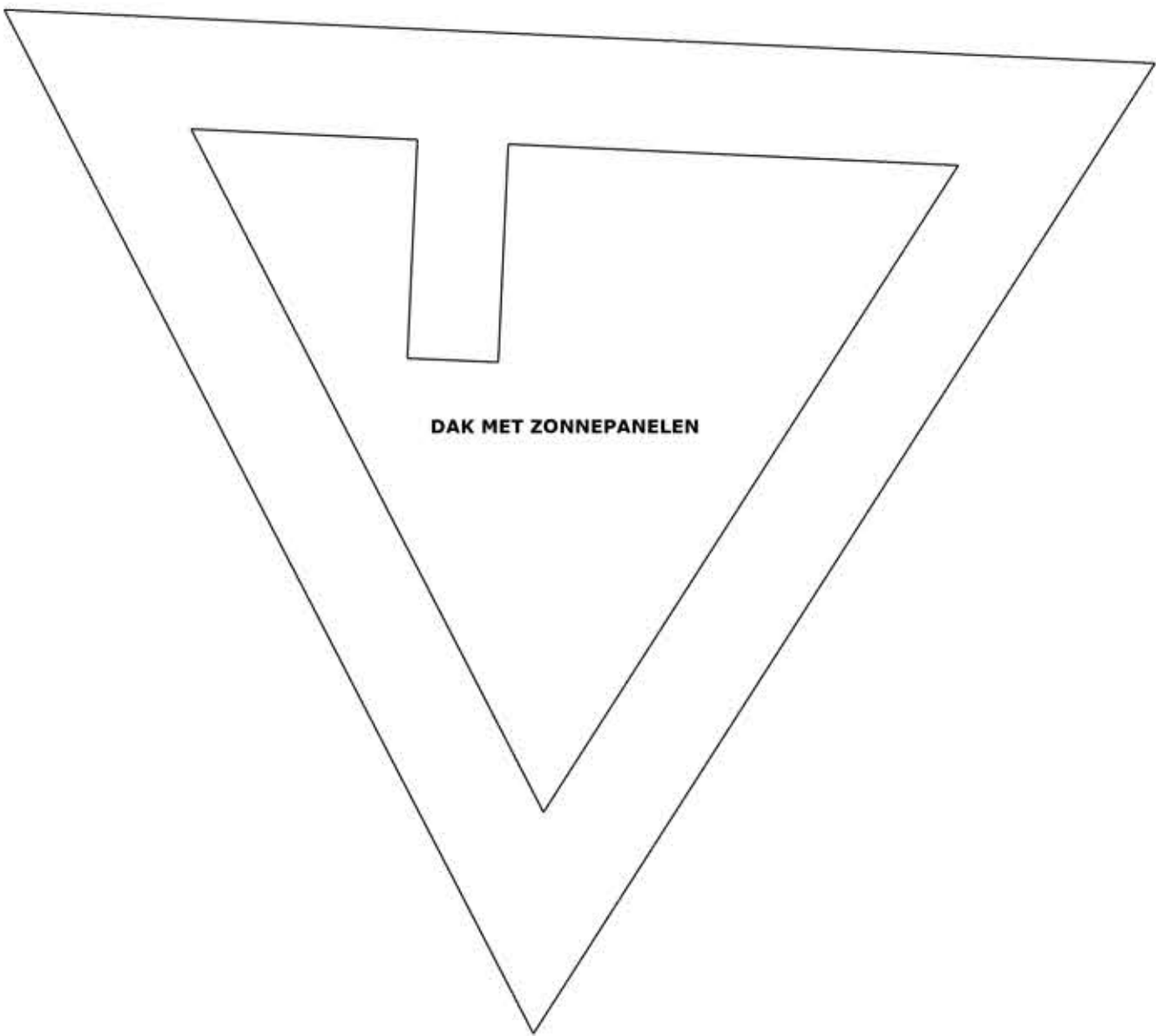

dakverdieping

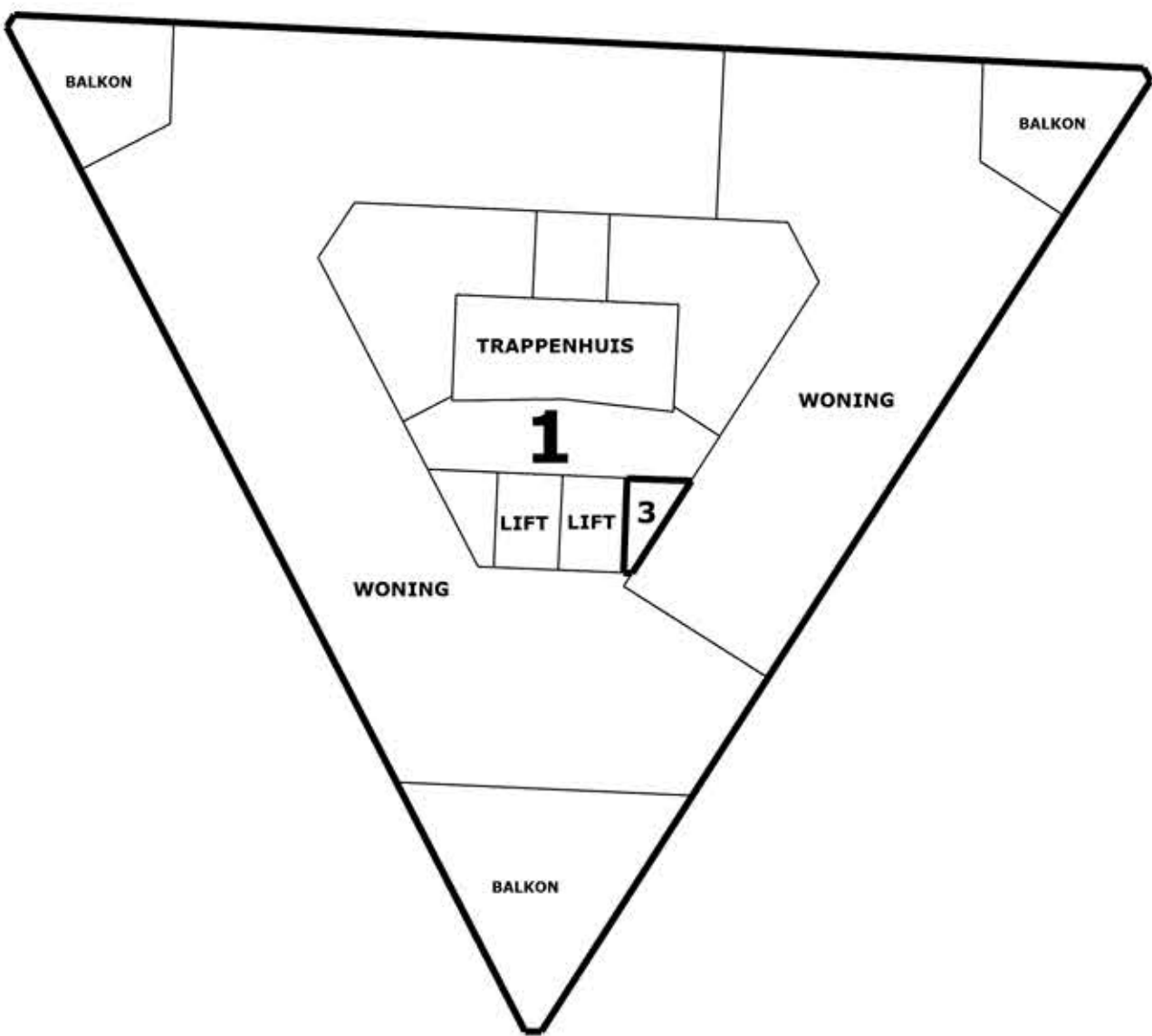

35e verdieping

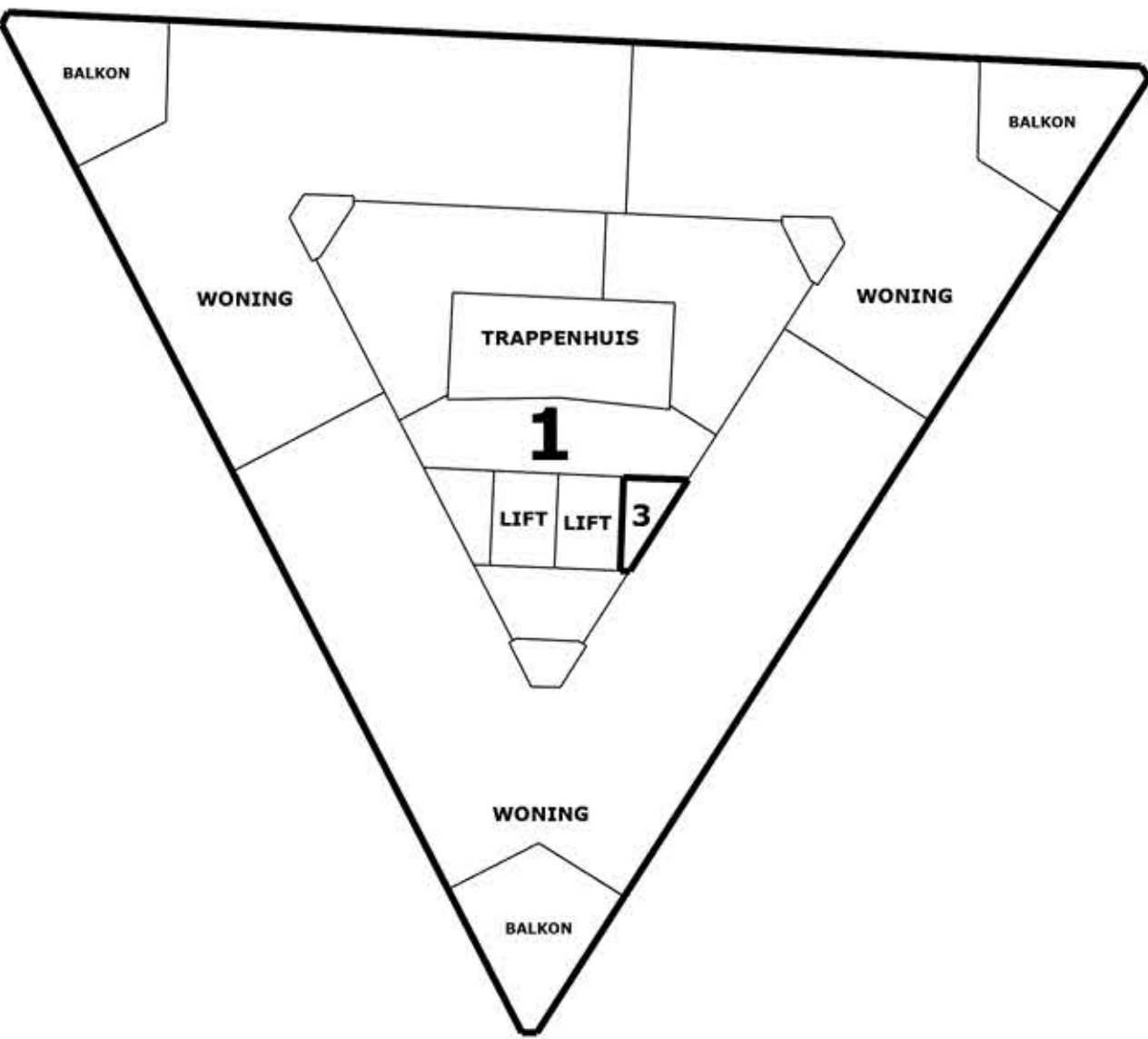

31e verdieping

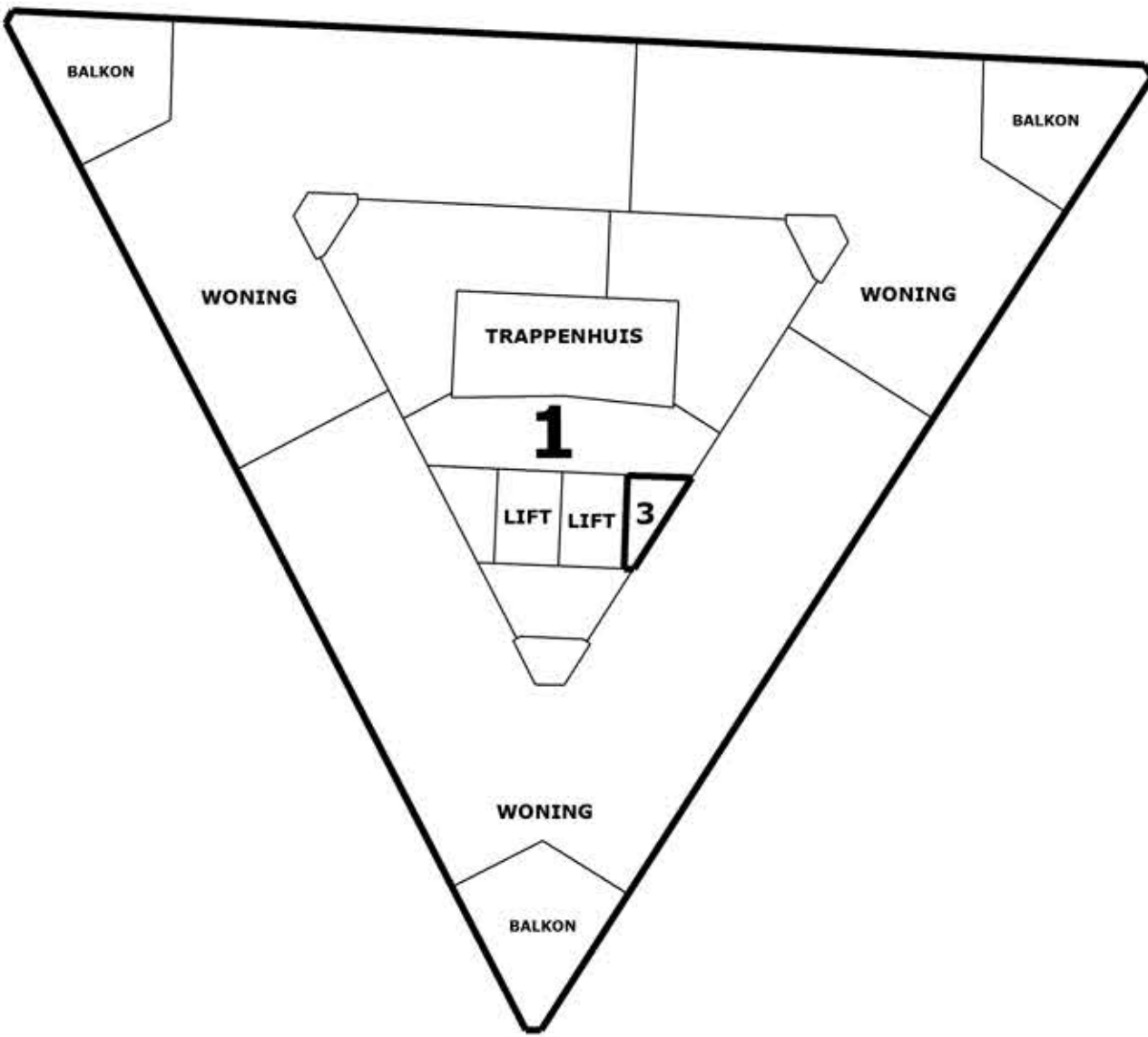

32e verdieping

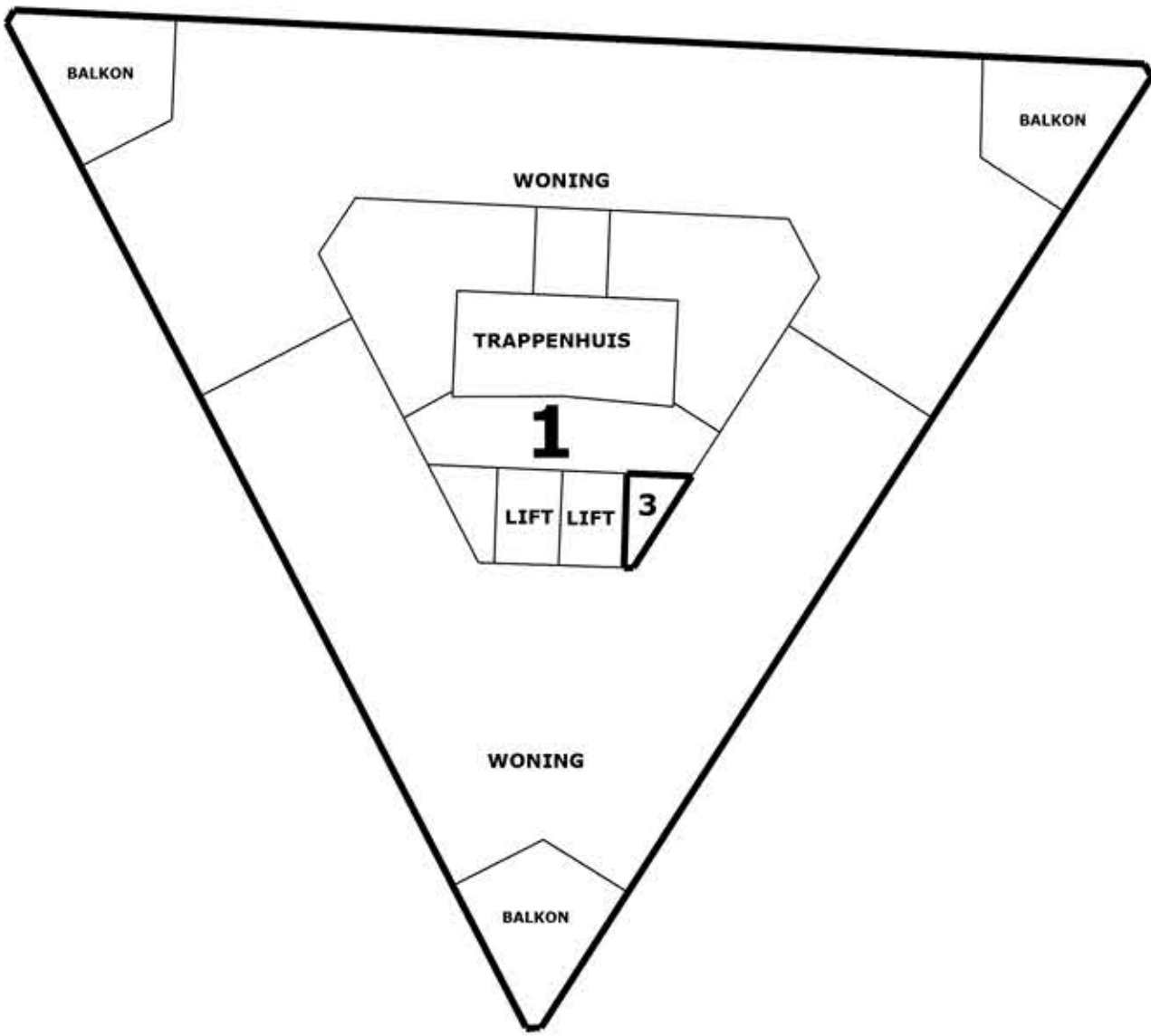

33e verdieping

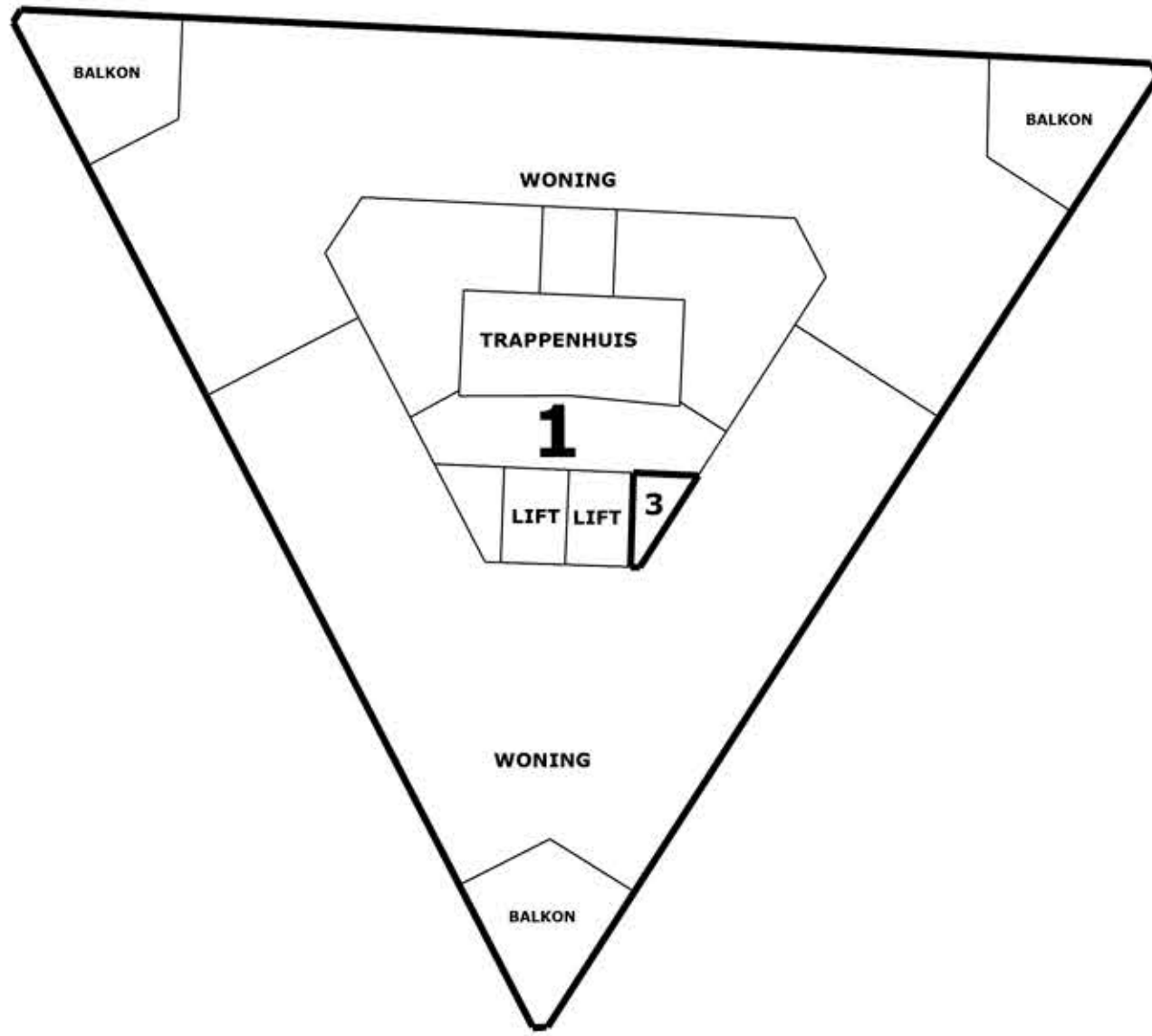

34e verdieping

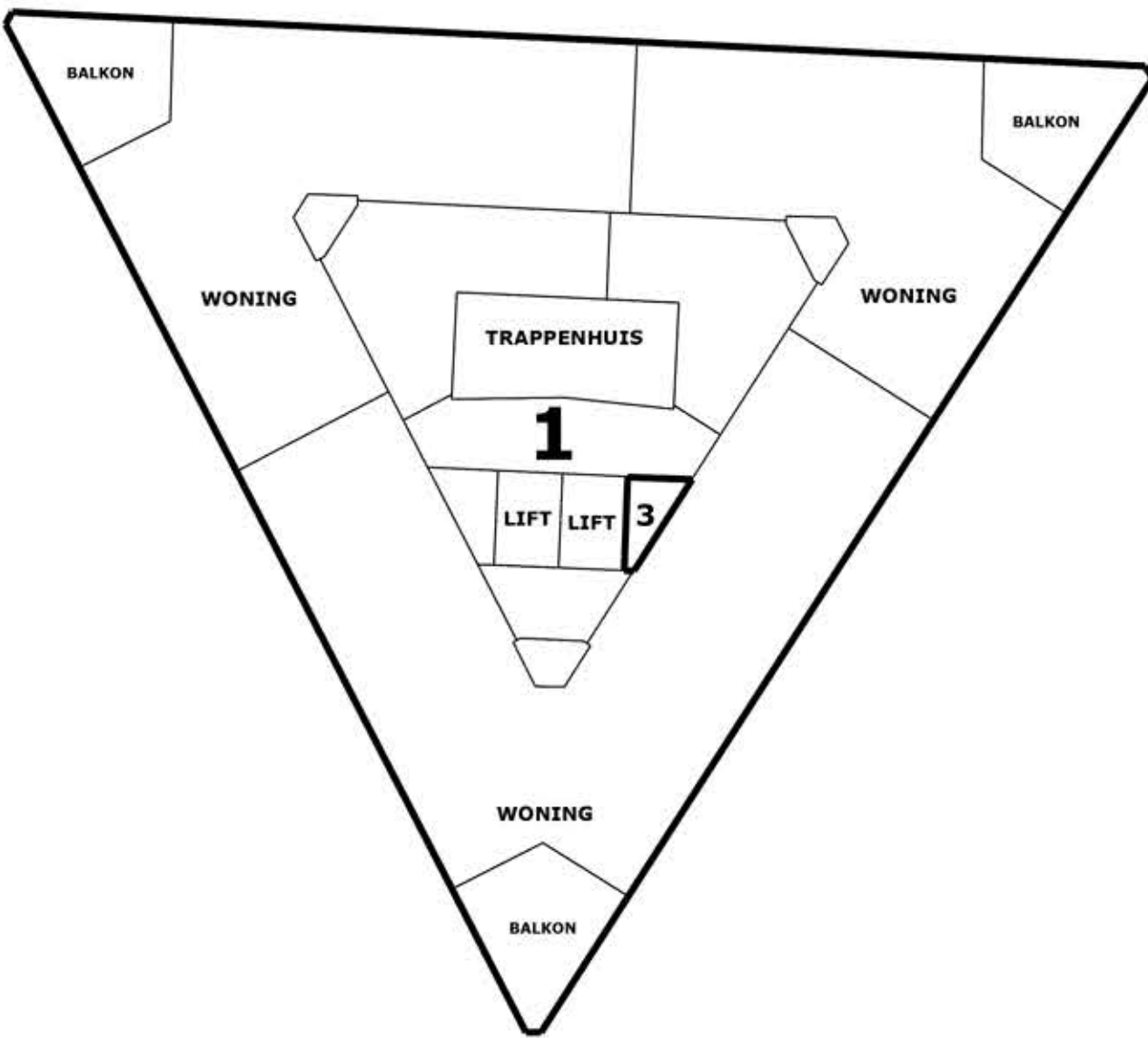

27e verdieping

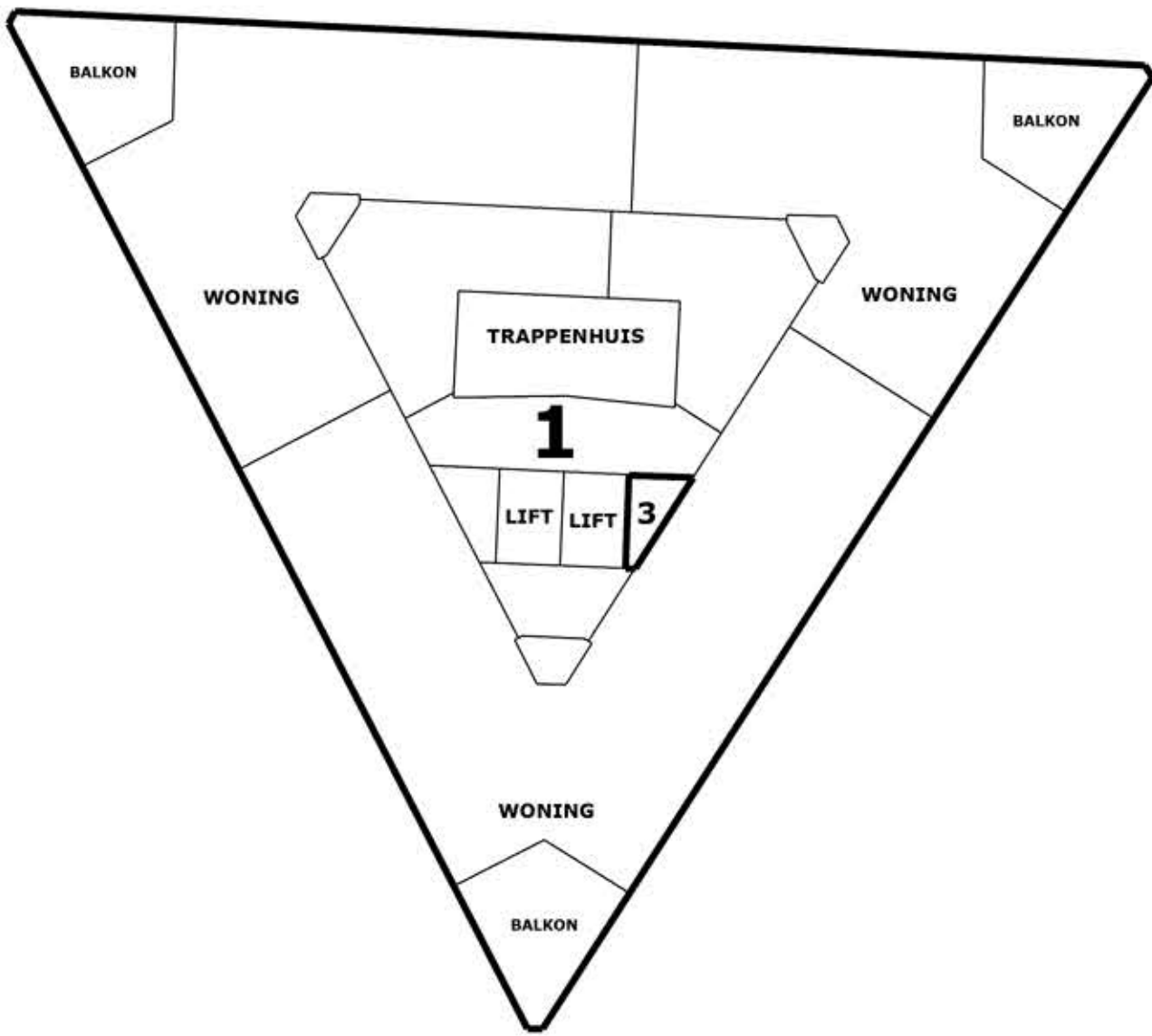

28e verdieping

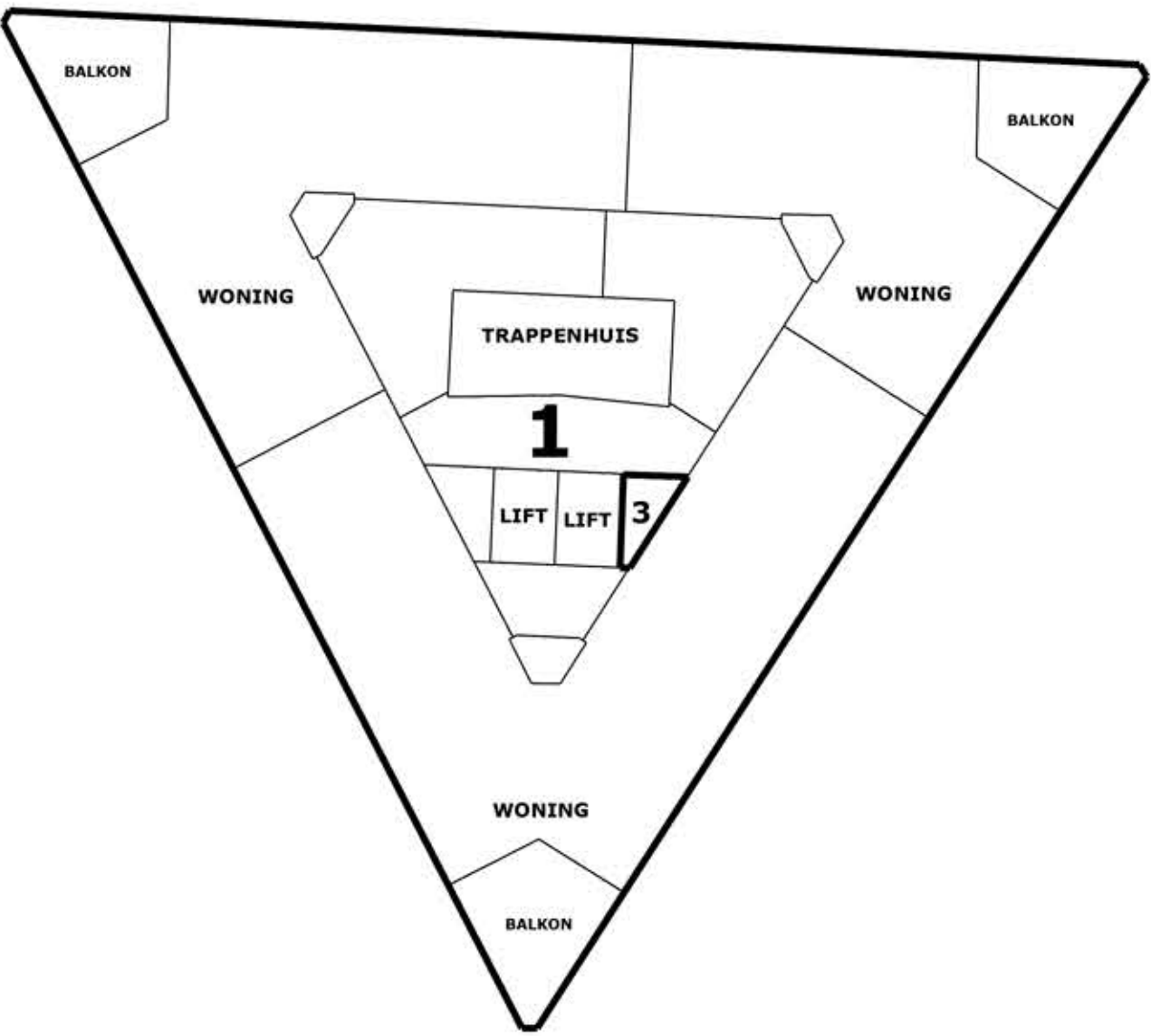

29e verdieping

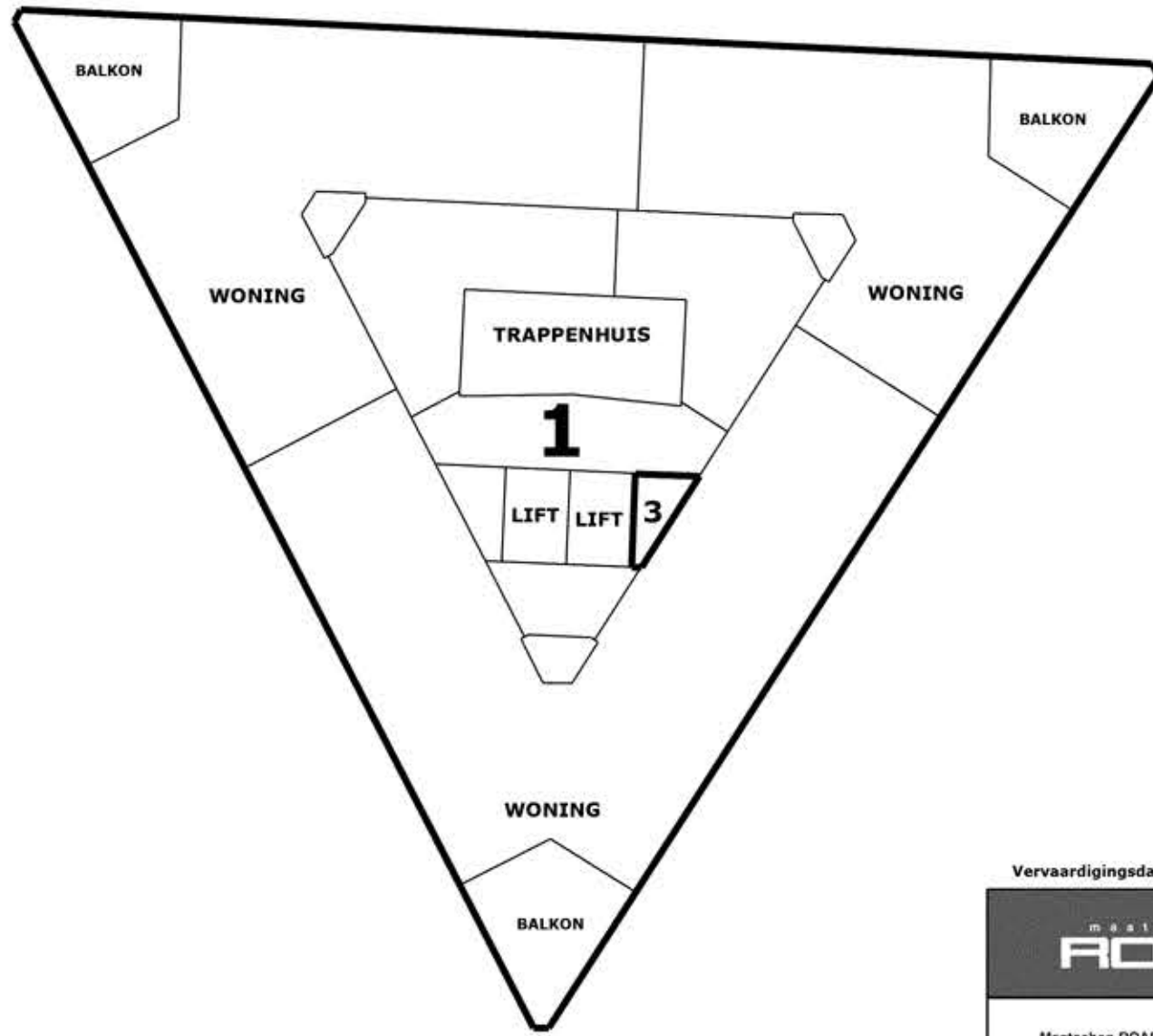

30e verdieping

